



*Threading Our Way To Excellence*

***Our Product Range covers almost all types of Thread Profiles***

ISO Metric, Unified, BSW / BSF / Whits, BA, BS Cycle, BS Conduit, Pipe threads like G / Rp, Pg, Acme, Stub Acme, Trapezoidal, Buttress, Saw Tooth.

Taper threads like NPT, NPTF/ PTF, BSPT, R/Rc, DIN 158.

Gauges for Gas cylinders & valves used for storage & transportation of Gas.

Gauges as per various specifications of American Petroleum Institute (API)

***Modern manufacturing plant with top class machine tools sourced from world leaders***



Thread Grinding section is climate controlled to maintain temperature of  $20 \pm 1^\circ$  Celsius & Humidity of  $50 \pm 10\%$  RH.



***Calibration Laboratory***

Accredited for ISO 17025-2017



- Separate and independent calibration laboratory, free from any influence.
- Measuring equipment are capable to check precision of gauges up to 0.0001 mm.
- Facilities to calibrate of Thread, plain gauges, masters & measuring instruments.
- Scope of accreditation & CMC are available on our website

*Thread Form checking on Zeiss Surfcom Contour Measuring instrument.*



*Thread Ring checking on SIP Universal Length measuring instrument.*

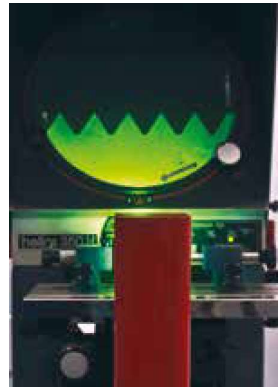



**'TRU-THREAD'** the name synonymous with Quality Thread gauges was established in 1982.

During this journey of close to four decades, we have built a world-class manufacturing and calibration facilities.

The excellent manufacturing setup facilitates us to produce gauges **'TRUE'** to the specification.

The precision of our manufactured gauges is checked in our well-equipped calibration lab.

Our calibration lab is accredited for **ISO 17025-2017**. Calibration certificates issued by our calibration lab are accepted across the world under **ILAC – Mutual Recognition Agreement**.

Precision machines & equipment alone cannot produce quality gauges. These are required to be handled by competent employees.

Our employees strive hard to achieve zero defect products & customer satisfaction.

Till date we have added more than three thousand customers to our family. Truthread is currently exporting to more than thirty countries across the globe. Eighty percent of our sales come from exports.

This journey would not have been possible without the trust, support, and confidence of our customers.

**-Team Tru-Thread**



Quality Management System compliant with **ISO 9001-2015** certified by **TÜV-SÜD**.



Accreditation for **ISO 17025-2017** recognised across the world through **ILAC-MRA**

Latest certificates are available on our website.

## ENVIRONMENTAL POLICY



We are conscious about the harmful effects of pollution & global warming on the society. We use all natural resources responsibly. Our manufacturing plant and head office is in a green campus. We generate 108 KW electricity through roof top solar panels. We have done rainwater harvesting to recharge the underground water. This is our small contribution to reduce the carbon footprint.



## MANUFACTURING PROGRAM

The type of gauges covered in the manufacturing program are -

- Plain plug gauges Go & Nogo to check holes/ internal diameters
- Plain ring gauges Go & Nogo to check shafts/ external diameters
- Plain setting rings
- Thread Plug gauges Go & Nogo OR taper to check Internal threads
- Thread Ring gauges Go & Nogo OR taper to check external threads
- Plain Plug gauges Go & Nogo to check minor diameters
- Plain Ring gauges Go & Nogo to check major diameter of threads
- Check Plug gauges to check NEW Go & Nogo / Taper Rings
- Wear Check Plug gauges to check used Go & Nogo / Taper Rings
- Double Length Setting Plug to set adjustable Go & Nogo Rings

## PRODUCT RANGE

'Truthread' covers one of the widest manufacturing range & Thread profiles.

Diameter & pitch/ TPI wise range	Diameter (mm - inch)		Pitch	TPI	Max. Taper
Thread Plug Gauges	1.6 – 350 mm	No.0 (0.06) – 14 Inch	0.35 – 12 mm	80 - 2	
Thread Ring Gauges	2 – 350 mm	No.4 (0.112) – 14 Inch	0.4 – 12 mm	48- 2	
Taper Thread Plug Gauges	5 – 350 mm	1/16 - 14 Inch	0.8- 12 mm	28 - 2	l in 4
Taper Thread Ring Gauges	5 – 300 mm	1/16 - 12 Inch	0.8- 12 mm	28 - 2	l in 4

This catalog covers only our partial manufacturing program of fast moving gauges.

The thread profiles not covered in this catalogue but included in our manufacturing program are (in alphabetical order)

Thread Profile	Specification
ACME Threads	ASME B1.15
ANPT Threads	ANSI SAE AS71051
BSW/BSF/Whits	BS 84 & BS 919 Part II
BA Threads	BS 93 & BS 919 Part II
BS Cycle Threads	BS 811 & BS 919 Part II
BS Conduit Threads	BS 31
Buttress Threads	BS 1657 - 7/45° & 0/52° Thread profile ANSI B 1.19 - 7/45° Thread profile
GAS Threads – Valve fittings & Cylinders	BS 341-1963
Saw Tooth Threads/ Metric Buttress	DIN 513 - 3/30° Thread profile
Stub ACME Threads	ASME B1.8
Trapezoidal Threads	ISO 2903/ ISO 2904 & DIN 103

### Gauges for Oil Industry

Line Pipe Threads	
External Upset (UP TPG) Threads	API 5B / ISO 11960
Non Upset Tubing (TBG) Threads	
Short & Long Casing Threads	
Sharp Threads Casing & Tubing	API 5A
Preferred & Non-Preferred Connections	API Spec 7/2 / ISO 10424 Part 2
Threads for Sucker roads	API 11AX / API 11 B
BECO Threads	
BPV ( Back Pressure valve ) Threads	

You can send inquiry / RFQ for these to our marketing department.

## PRODUCT MARKING

All products are marked with this Logo



\* Logos used in this Catalogue are registered Trademark of  
"Truththread Gauges & Tools Pvt. Ltd."

## HEAT TREATMENT

All gauges are hardened & double tempered to hardness of 60-62 HRC in our modern Heat treatment facility. The gauges are stress relieved/ dimensionally stabilized before finish grinding.

## GAUGE MATERIAL

We use DIN 1.2510/AISI O-1 & DIN 1.350 / SAE 5210 material.  
All incoming material is tested for chemical composition.



## INDEX

Contents	Page No
Plain Plugs	03
Plain Rings, Setting Rings	04
ISO Metric - M	05
ISO Metric - MF	09
MJ Threads	21
Metric STI / Wire Threads	22
UNC Threads	23
UNF Threads	26
UNEF Threads	28
UN Threads	30

Contents	Page No
UNJ Threads	34
UNC / UNF - STI / Wire Threads	37
G -Pipe Threads - ISO 228	38
P G Threads	40
(Whitworth) pipe threads - DIN 2999	41
R/Rc/Rp Threads - ISO 7	42
NPT Threads	43
NPTF Threads	44
NGT Threads	45
VALVE Fittings other than LPG - BS EN ISO 11363	46

### Tips to use this Catalogue for ordering

- In this Catalogue the Order code is of 15 characters. The order code column has 11 characters, rest 4 characters are to be selected from other columns.
- These four characters indicate tolerance class, Go, Nogo OR Go & Nogo, right hand or left hand threads.
- **These 11+4 characters form complete order code.**
- **While ordering please inform us complete fifteen character code.**
- For Plain Gauges, inform us the eleven character code & size (diameter & tolerance class)



We supply set of measuring pins, Plain Plug Gauges, Plain Ring Gauges, Thread Plug & Thread Ring gauges. These gauges are packed in wooden box.

Some examples are.

- Plain plug Gauges of sizes  $\phi$  3 H7,  $\phi$  4H7  $\phi$  5 H7,  $\phi$  6 H7,  $\phi$  8 H7,  $\phi$  10 H7,  $\phi$  12 H7.
- Plain ring Gauges of sizes  $\phi$  3 h7,  $\phi$  5 h7,  $\phi$  6 h7,  $\phi$  8 h7,  $\phi$  10 h7,  $\phi$  12 h7.
- Thread Plugs of sizes M3-6H, M4-6H, M5-6H, M6-6H, M8-6H, M10-6H, M12-6H.

*The content of these sets can be customized.*



## CUSTOMIZED GAUGING SOLUTIONS

We design & offer Plain/ Thread Gauging solutions for special requirements like,

- To check the thread depth of a hole or tapped hole.
- To check the squareness of faces with respect to threads.
- To check the concentricity of Plain bore with respect to threads.
- Any other requirement,

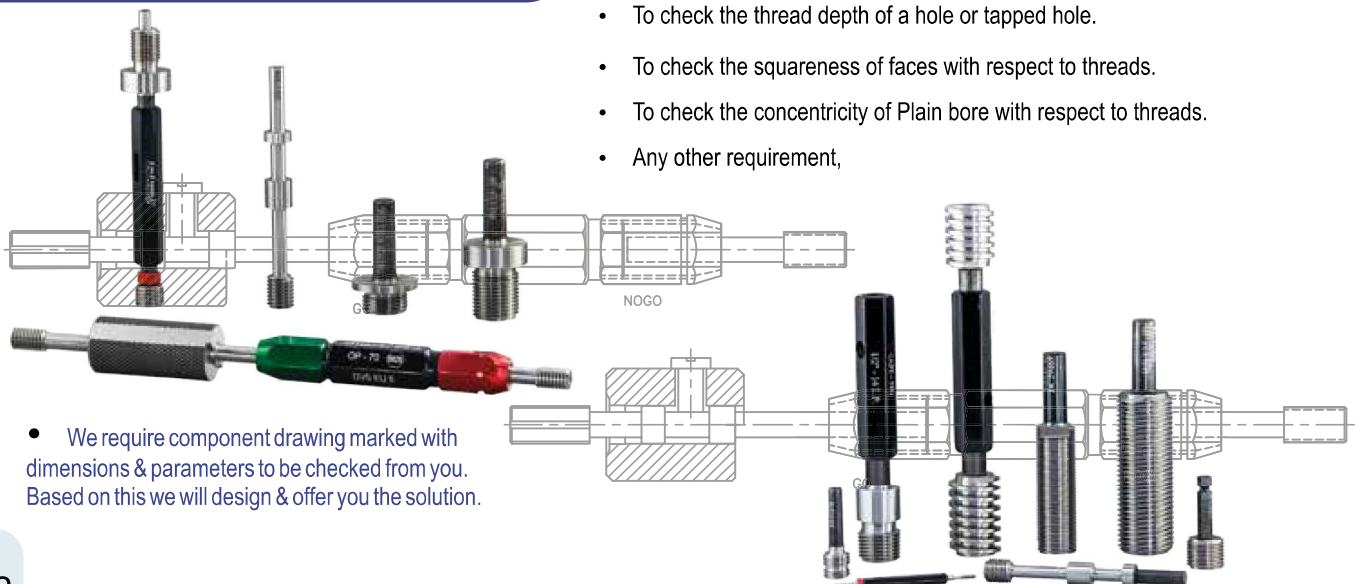

- We require component drawing marked with dimensions & parameters to be checked from you. Based on this we will design & offer you the solution.

Specification: ISO 286, ISO 1938/  
DIN 2245, DIN 7150



Reversible Pin Design up to 5mm



Taperlock Design 5-40mm



Trilock Single end for Dia. above 65mm

- ✓ Available in stock
- Manufactured against order

Our manufacturing program includes diameter up to 300mm. PRICES ON REQUEST

Dia	Catalogue Code	Plug H7			Plug # Tolerance other than H7			Plug - Special Tolerance *		
		Go & Nogo	Go	Nogo	Go & Nogo	Go	Nogo	Go & Nogo	Go	Nogo
Over - upto		H7 D0	H7 G0	H7 N0	12-15 characters are absent in the code, see footnote *					
2-4	P PI 00004 000	✓	○	○	○	○	○	○	○	○
4-6	P PI 00006 000	✓	○	○	○	○	○	○	○	○
6-8	P PI 00008 000	✓	○	○	○	○	○	○	○	○
8-10	P PI 00010 000	✓	○	○	○	○	○	○	○	○
10-12	P PI 00012 000	✓	○	○	○	○	○	○	○	○
12-14	P PI 00014 000	✓	○	○	○	○	○	○	○	○
14-16	P PI 00016 000	✓	○	○	○	○	○	○	○	○
16-18	P PI 00018 000	✓	○	○	○	○	○	○	○	○
18-20	P PI 00020 000	✓	○	○	○	○	○	○	○	○
20-22	P PI 00022 000	✓	○	○	○	○	○	○	○	○
22-24	P PI 00024 000	✓	○	○	○	○	○	○	○	○
24-26	P PI 00026 000	✓	○	○	○	○	○	○	○	○
26-28	P PI 00028 000	✓	○	○	○	○	○	○	○	○
28-30	P PI 00030 000	✓	○	○	○	○	○	○	○	○
30-32	P PI 00032 000	✓	○	○	○	○	○	○	○	○
32-34	P PI 00034 000	✓	○	○	○	○	○	○	○	○
34-36	P PI 00036 000	✓	○	○	○	○	○	○	○	○
36-38	P PI 00038 000	✓	○	○	○	○	○	○	○	○
38-40	P PI 00040 000	✓	○	○	○	○	○	○	○	○
40-42	P PI 00042 000	✓	○	○	○	○	○	○	○	○
42-45	P PI 00045 000	✓	○	○	○	○	○	○	○	○
45-50	P PI 00050 000	✓	○	○	○	○	○	○	○	○
50-55	P PI 00055 000	✓	○	○	○	○	○	○	○	○
55-60	P PI 00060 000	✓	○	○	○	○	○	○	○	○
60-65	P PI 00065 000	✓	○	○	○	○	○	○	○	○
65-70	P PI 00070 000	NA	○	○	NA	○	○	NA	○	○
70-75	P PI 00075 000	NA	○	○	NA	○	○	NA	○	○
75-80	P PI 00080 000	NA	○	○	NA	○	○	NA	○	○
80-85	P PI 00085 000	NA	○	○	NA	○	○	NA	○	○
85-90	P PI 00090 000	NA	○	○	NA	○	○	NA	○	○
90-95	P PI 00095 000	NA	○	○	NA	○	○	NA	○	○
95-100	P PI 00100 000	NA	○	○	NA	○	○	NA	○	○

Our manufacturing program covers-

# Tolerance classes specified in ISO/DIN like H8, G7, D5 & JS, etc.

\* Special tolerances specified by customer like Dia.35.000 +0.150 mm OR Dia.20.000 + 0.1/- 0.050 mm

**\* In your order please specify Diameter & tolerance in addition to the 11 characters order code like**

**P PI 00045 – φ48 G8 and P PI 00012 000 φ12 +0.1 mm**

**For plain gauges catalogue code is of only 11 characters.**

NA - Not Applicable

# PLAIN / SETTING RING



Specification: Setting Rings: DIN 2250-1 C  
Limit Rings: DIN 2250/DIN 2254



- ✓ Available in stock
- Manufactured against order

Our manufacturing program includes diameter up to 300mm. PRICES ON REQUEST

Dia	Catalogue Code	Go Ring	Nogo Ring	Go Ring	Nogo Ring	Go Ring		Setting Ring
		h7	h7	# Tolerance other than h7	* Special Tolerance			
Over - upto		H7 G0	H7 N0	12-15 characters are absent in the code, see footnote *				00S0
3	R PI 00003 000	✓	✓	○	○	○	○	✓
4	R PI 00004 000	✓	✓	○	○	○	○	✓
5	R PI 00005 000	✓	✓	○	○	○	○	✓
6	R PI 00006 000	✓	✓	○	○	○	○	✓
7	R PI 00007 000	✓	✓	○	○	○	○	✓
8	R PI 00008 000	✓	✓	○	○	○	○	✓
9	R PI 00009 000	✓	✓	○	○	○	○	✓
10	R PI 00010 000	✓	✓	○	○	○	○	✓
10-12	R PI 00012 000	✓	✓	○	○	○	○	✓
12-14	R PI 00014 000	✓	✓	○	○	○	○	✓
14-16	R PI 00016 000	✓	✓	○	○	○	○	✓
16-18	R PI 00018 000	✓	✓	○	○	○	○	✓
18-20	R PI 00020 000	✓	✓	○	○	○	○	✓
20-23	R PI 00023 000	○	○	○	○	○	○	✓
23-26	R PI 00026 000	○	○	○	○	○	○	✓
26-29	R PI 00029 000	○	○	○	○	○	○	✓
29-32	R PI 00032 000	○	○	○	○	○	○	✓
32-35	R PI 00035 000	○	○	○	○	○	○	✓
35-40	R PI 00040 000	○	○	○	○	○	○	✓
40-45	R PI 00045 000	○	○	○	○	○	○	✓
45-50	R PI 00050 000	○	○	○	○	○	○	✓
50-55	R PI 00055 000	○	○	○	○	○	○	○
55-60	R PI 00060 000	○	○	○	○	○	○	○
60-65	R PI 00065 000	○	○	○	○	○	○	○
65-70	R PI 00070 000	○	○	○	○	○	○	○
70-75	R PI 00075 000	○	○	○	○	○	○	○
75-80	R PI 00080 000	○	○	○	○	○	○	○
80-85	R PI 00085 000	○	○	○	○	○	○	○
85-90	R PI 00090 000	○	○	○	○	○	○	○
90-95	R PI 00095 000	○	○	○	○	○	○	○
95-100	R PI 00100 000	○	○	○	○	○	○	○

**Our manufacturing program covers-**

# Tolerance classes specified in ISO/ DIN like h8, g7 &, d5, js, etc.

\* Special tolerances specified by customer like Dia.25.000 + 0.100 mm OR Dia.12.000 + 0.050 - 0.025 mm

**\* In your order please specify Diameter & tolerance in addition to 11 characters the order code like R PI 00090 000 – φ95 Setting ring and R PI 00010 000 φ10 g7 OR R PI 00020 000 φ18 +0.1 – 0.05 mm**

**For plain gauges catalogue code is of only 11 characters.**



Specification: ISO 965, ISO 1502/ DIN 13

**Application:** General purpose fastening in Metric / SI units. Most commonly used threads.



✓ Available in stock ○ Manufactured against order

All the Sizes & Tolerances specified in DIN / ISO are covered in our manufacturing program. **PRICES ON REQUEST**

Size		Catalogue Code							Go & Nogo Plain Plug to check Minor Dia. 6H
Diameter	Pitch		Go & Nogo Plug 6H RH	Go Plug 6H RH	Nogo Plug 6H RH	Go & Nogo Plug 6H LH	Go Plug 6H LH	Nogo Plug 6H LH	
			6H DR	6H GR	6H NR	6H DL	6H GL	6H NL	6H D0
M1.6	0.35	P MI 00016 035	✓	○	○	✓	○	○	✓
M1.8	0.35	P MI 00018 035	✓	○	○	✓	○	○	✓
M2	0.4	P MI 00002 040	✓	○	○	✓	○	○	✓
M2.2	0.45	P MI 00022 045	✓	○	○	✓	○	○	✓
M2.5	0.45	P MI 00025 045	✓	○	○	✓	○	○	✓
M3	0.5	P MI 00003 050	✓	○	○	✓	○	○	✓
M3.5	0.6	P MI 00035 060	✓	○	○	✓	○	○	✓
M4	0.7	P MI 00004 070	✓	○	○	✓	○	○	✓
M4.5	0.75	P MI 00045 075	✓	○	○	✓	○	○	✓
M5	0.8	P MI 00005 080	✓	○	○	✓	○	○	✓
M6	1	P MI 00006 100	✓	○	○	✓	○	○	✓
M7	1	P MI 00007 100	✓	○	○	✓	○	○	✓
M8	1.25	P MI 00008 125	✓	○	○	✓	○	○	✓
M9	1.25	P MI 00009 125	✓	○	○	✓	○	○	✓
M10	1.5	P MI 00010 150	✓	○	○	✓	○	○	✓
M11	1.5	P MI 00011 150	✓	○	○	✓	○	○	✓
M12	1.75	P MI 00012 175	✓	○	○	✓	○	○	✓
M14	2	P MI 00014 200	✓	○	○	✓	○	○	✓
M16	2	P MI 00016 200	✓	○	○	✓	○	○	✓
M18	2.5	P MI 00018 250	✓	○	○	✓	○	○	✓
M20	2.5	P MI 00020 250	✓	○	○	✓	○	○	✓
M22	2.5	P MI 00022 250	✓	○	○	✓	○	○	○
M24	3	P MI 00024 300	✓	○	○	✓	○	○	○
M27	3	P MI 00027 300	✓	○	○	✓	○	○	○
M30	3.5	P MI 00030 350	✓	○	○	✓	○	○	○
M33	3.5	P MI 00033 350	✓	○	○	✓	○	○	○
M36	4	P MI 00036 400	✓	○	○	✓	○	○	○
M39	4	P MI 00039 400	✓	○	○	✓	○	○	○
M42	4.5	P MI 00042 450	✓	○	○	✓	○	○	○
M45	4.5	P MI 00045 450	NA	✓	✓	NA	✓	✓	○
M48	5	P MI 00048 500	NA	✓	✓	NA	✓	✓	○
M52	5	P MI 00052 500	NA	✓	✓	NA	✓	✓	○
M56	5.5	P MI 00056 550	NA	✓	✓	NA	✓	✓	○
M60	5.5	P MI 00060 550	NA	✓	✓	NA	✓	✓	○
M64	6	P MI 00064 600	NA	✓	✓	NA	✓	✓	○
M68	6	P MI 00068 600	NA	✓	✓	NA	✓	✓	○

NA - Not Applicable



Specification: ISO 965, ISO 1502/ DIN 13

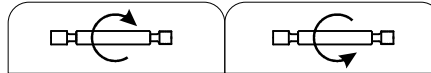

✓ Available in stock   ○ Manufactured against order

All the Sizes & Tolerances specified in DIN / ISO are covered in our manufacturing program. PRICES ON REQUEST

Size		Catalogue Code	Go & Nogo	Go & Nogo	Go & Nogo	Go & Nogo	Go & Nogo Plain Plug to check Minor Dia.	
Diameter	Pitch		6G RH	4H RH	6G LH	4H LH	6G	4H
			6G DR	4H DR	6G DL	4H DL	6G D0	4H D0
M1.6	0.35	P MI 00016 035	✓	○	✓	○	○	○
M1.8	0.35	P MI 00018 035	✓	○	✓	○	○	○
M2	0.4	P MI 00002 040	✓	○	✓	○	○	○
M2.2	0.45	P MI 00022 045	✓	○	✓	○	○	○
M2.5	0.45	P MI 00025 045	✓	○	✓	○	○	○
M3	0.5	P MI 00003 050	✓	○	✓	○	✓	○
M3.5	0.6	P MI 00035 060	✓	○	✓	○	✓	○
M4	0.7	P MI 00004 070	✓	○	✓	○	✓	○
M4.5	0.75	P MI 00045 075	✓	○	✓	○	✓	○
M5	0.8	P MI 00005 080	✓	○	✓	○	✓	○
M6	1	P MI 00006 100	✓	○	✓	○	✓	○
M7	1	P MI 00007 100	✓	○	✓	○	✓	○
M8	1.25	P MI 00008 125	✓	○	✓	○	✓	○
M9	1.25	P MI 00009 125	✓	○	✓	○	✓	○
M10	1.5	P MI 00010 150	✓	○	✓	○	✓	○
M11	1.5	P MI 00011 150	✓	○	✓	○	✓	○
M12	1.75	P MI 00012 175	✓	○	✓	○	✓	○
M14	2	P MI 00014 200	✓	○	✓	○	✓	○
M16	2	P MI 00016 200	✓	○	✓	○	✓	○
M18	2.5	P MI 00018 250	✓	○	✓	○	✓	○
M20	2.5	P MI 00020 250	✓	○	✓	○	✓	○
M22	2.5	P MI 00022 250	✓	○	✓	○	✓	○
M24	3	P MI 00024 300	✓	○	✓	○	✓	○
M27	3	P MI 00027 300	✓	○	✓	○	✓	○
M30	3.5	P MI 00030 350	✓	○	✓	○	○	○
M33	3.5	P MI 00033 350	✓	○	✓	○	○	○
M36	4	P MI 00036 400	✓	○	✓	○	○	○
M39	4	P MI 00039 400	✓	○	✓	○	○	○



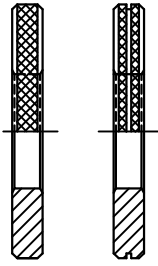

✓ Available in stock   ○ Manufactured against order

 All the Sizes & Tolerances specified in DIN / ISO are covered in our manufacturing program. **PRICES ON REQUEST**

Size			Catalogue Code	Go Ring	Nogo Ring	Go Ring	Nogo Ring	Go Ring	Nogo Ring
Diameter	Pitch	6g RH		6g RH	6e RH	6e RH	6h RH	6h RH	
		6G GR		6G NR	6E GR	6E NR	6H GR	6H NR	
M1.6	0.35	R MI 00016 035	✓	✓	○	○	○	○	
M1.8	0.35	R MI 00018 035	✓	✓	○	○	○	○	
M2	0.4	R MI 00002 040	✓	✓	○	○	○	○	
M2.2	0.45	R MI 00022 045	✓	✓	○	○	○	○	
M2.5	0.45	R MI 00025 045	✓	✓	○	○	○	○	
M3	0.5	R MI 00003 050	✓	✓	✓	✓	✓	✓	
M3.5	0.6	R MI 00035 060	✓	✓	✓	✓	✓	✓	
M4	0.7	R MI 00004 070	✓	✓	✓	✓	✓	✓	
M4.5	0.75	R MI 00045 075	✓	✓	✓	✓	✓	✓	
M5	0.8	R MI 00005 080	✓	✓	✓	✓	✓	✓	
M6	1	R MI 00006 100	✓	✓	✓	✓	✓	✓	
M7	1	R MI 00007 100	✓	✓	✓	✓	✓	✓	
M8	1.25	R MI 00008 125	✓	✓	✓	✓	✓	✓	
M9	1.25	R MI 00009 125	✓	✓	✓	✓	✓	✓	
M10	1.5	R MI 00010 150	✓	✓	✓	✓	✓	✓	
M11	1.5	R MI 00011 150	✓	✓	✓	✓	✓	✓	
M12	1.75	R MI 00012 175	✓	✓	✓	✓	✓	✓	
M14	2	R MI 00014 200	✓	✓	✓	✓	✓	✓	
M16	2	R MI 00016 200	✓	✓	✓	✓	✓	✓	
M18	2.5	R MI 00018 250	✓	✓	✓	✓	✓	✓	
M20	2.5	R MI 00020 250	✓	✓	✓	✓	✓	✓	
M22	2.5	R MI 00022 250	✓	✓	✓	✓	✓	✓	
M24	3	R MI 00024 300	✓	✓	✓	✓	✓	✓	
M27	3	R MI 00027 300	✓	✓	✓	✓	✓	✓	
M30	3.5	R MI 00030 350	✓	✓	○	○	○	○	
M33	3.5	R MI 00033 350	✓	✓	○	○	○	○	
M36	4	R MI 00036 400	✓	✓	○	○	○	○	
M39	4	R MI 00039 400	✓	✓	○	○	○	○	
M42	4.5	R MI 00042 450	✓	✓	○	○	○	○	
M45	4.5	R MI 00045 450	✓	✓	○	○	○	○	
M48	5	R MI 00048 500	✓	✓	○	○	○	○	
M52	5	R MI 00052 500	✓	✓	○	○	○	○	
M56	5.5	R MI 00056 550	✓	✓	○	○	○	○	
M60	5.5	R MI 00060 550	✓	✓	○	○	○	○	
M64	6	R MI 00064 600	✓	✓	○	○	○	○	
M68	6	R MI 00068 600	✓	✓	○	○	○	○	



Specification: ISO 965, ISO 1502/ DIN 13

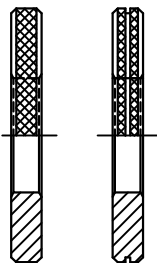

✓ Available in stock    ○ Manufactured against order

All the Sizes & Tolerances specified in DIN / ISO are covered in our manufacturing program. PRICES ON REQUEST

Size			Catalogue Code	Go Ring	Nogo Ring	Go Ring	Nogo Ring	Go Ring	Nogo Ring
Diameter	Pitch	6g LH		6g LH	6e LH	6e LH	6h LH	6h LH	
			6G GL	6G NL	6E GL	6E NL	6H GL	6H NL	
M1.6	0.35	R MI 00016 035	✓	✓	○	○	○	○	
M1.8	0.35	R MI 00018 035	✓	✓	○	○	○	○	
M2	0.4	R MI 00002 040	✓	✓	○	○	○	○	
M2.2	0.45	R MI 00022 045	✓	✓	○	○	○	○	
M2.5	0.45	R MI 00025 045	✓	✓	○	○	○	○	
M3	0.5	R MI 00003 050	✓	✓	○	○	○	○	
M3.5	0.6	R MI 00035 060	✓	✓	○	○	○	○	
M4	0.7	R MI 00004 070	✓	✓	○	○	○	○	
M4.5	0.75	R MI 00045 075	✓	✓	○	○	○	○	
M5	0.8	R MI 00005 080	✓	✓	○	○	○	○	
M6	1	R MI 00006 100	✓	✓	○	○	○	○	
M7	1	R MI 00007 100	✓	✓	○	○	○	○	
M8	1.25	R MI 00008 125	✓	✓	○	○	○	○	
M9	1.25	R MI 00009 125	✓	✓	○	○	○	○	
M10	1.5	R MI 00010 150	✓	✓	○	○	○	○	
M11	1.5	R MI 00011 150	✓	✓	○	○	○	○	
M12	1.75	R MI 00012 175	✓	✓	○	○	○	○	
M14	2	R MI 00014 200	✓	✓	○	○	○	○	
M16	2	R MI 00016 200	✓	✓	○	○	○	○	
M18	2.5	R MI 00018 250	✓	✓	○	○	○	○	
M20	2.5	R MI 00020 250	✓	✓	○	○	○	○	
M22	2.5	R MI 00022 250	✓	✓	○	○	○	○	
M24	3	R MI 00024 300	✓	✓	○	○	○	○	
M27	3	R MI 00027 300	✓	✓	○	○	○	○	
M30	3.5	R MI 00030 350	✓	✓	○	○	○	○	
M33	3.5	R MI 00033 350	✓	✓	○	○	○	○	
M36	4	R MI 00036 400	✓	✓	○	○	○	○	
M39	4	R MI 00039 400	✓	✓	○	○	○	○	
M42	4.5	R MI 00042 450	✓	✓	○	○	○	○	
M45	4.5	R MI 00045 450	✓	✓	○	○	○	○	
M48	5	R MI 00048 500	✓	✓	○	○	○	○	
M52	5	R MI 00052 500	✓	✓	○	○	○	○	
M56	5.5	R MI 00056 550	✓	✓	○	○	○	○	
M60	5.5	R MI 00060 550	✓	✓	○	○	○	○	
M64	6	R MI 00064 600	✓	✓	○	○	○	○	
M68	6	R MI 00068 600	✓	✓	○	○	○	○	



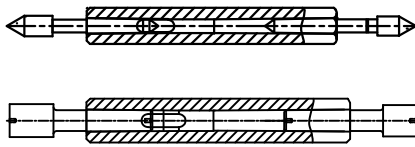

 All the Sizes & Tolerances specified in DIN / ISO are covered in our manufacturing program. **PRICES ON REQUEST**

✓ Available in stock   ○ Manufactured against order

Size		Catalogue Code							Go & Nogo Plain Plug to check Minor Dia.	
			6H RH	4H RH	6G RH	6H LH	4H LH	6G LH	6H	6G
Diameter	Pitch		6H DR	4H DR	6G DR	6H DL	4H DL	6G DL	6H D0	6G D0
M2.5	0.35	P MI 00025 035	✓	✓	○	✓	○	○	○	○
M3	0.35	P MI 00003 035	✓	✓	○	✓	○	○	○	○
M4	0.5	P MI 00004 050	✓	✓	✓	✓	○	○	○	○
M5	0.75	P MI 00005 075	✓	✓	✓	✓	○	○	○	○
	0.5	P MI 00005 050	✓	✓	✓	✓	○	○	○	○
M6	0.75	P MI 00006 075	✓	○	○	✓	○	○	○	○
	0.5	P MI 00006 050	✓	○	○	✓	○	○	○	○
M7	0.75	P MI 00007 075	✓	○	○	○	○	○	○	○
	0.5	P MI 00007 050	✓	○	○	○	○	○	○	○
M8	1	P MI 00008 100	✓	✓	✓	✓	○	✓	✓	○
	0.75	P MI 00008 075	✓	✓	✓	○	○	○	○	○
	0.5	P MI 00008 050	✓	○	○	○	○	○	○	○
M9	1	P MI 00009 100	✓	✓	✓	✓	○	○	○	○
	0.75	P MI 00009 075	✓	○	○	○	○	○	○	○
	0.5	P MI 00009 050	✓	○	✓	○	○	○	○	○
M10	1.25	P MI 00010 125	✓	✓	✓	✓	○	✓	✓	○
	1	P MI 00010 100	✓	✓	✓	✓	○	✓	✓	○
	0.75	P MI 00010 075	✓	○	○	○	○	○	○	○
	0.5	P MI 00010 050	✓	○	○	○	○	○	○	○
M11	1	P MI 00011 100	✓	✓	✓	○	○	○	○	○
M12	1.5	P MI 00012 150	✓	✓	✓	✓	○	✓	✓	○
	1.25	P MI 00012 125	✓	✓	✓	✓	○	✓	✓	○
	1	P MI 00012 100	✓	✓	✓	✓	○	○	○	○
	0.75	P MI 00012 075	✓	○	○	○	○	○	○	○
	0.5	P MI 00012 050	✓	○	○	○	○	○	○	○
M14	1.5	P MI 00014 150	✓	✓	✓	✓	○	✓	✓	○
	1.25	P MI 00014 125	✓	✓	✓	✓	○	✓	✓	○
	1	P MI 00014 100	✓	✓	✓	✓	○	○	○	○
	0.75	P MI 00014 075	✓	○	○	○	○	○	○	○
M15	1	P MI 00015 100	✓	✓	✓	○	○	○	○	○
M16	1.5	P MI 00016 150	✓	✓	✓	✓	○	✓	✓	○
	1.25	P MI 00016 125	✓	✓	✓	✓	○	✓	○	○
	1	P MI 00016 100	✓	✓	✓	✓	○	○	○	○
	0.75	P MI 00016 075	✓	○	○	○	○	○	○	○
M17	1	P MI 00017 100	✓	○	○	○	○	○	○	○
M18	2	P MI 00018 200	✓	✓	✓	✓	○	✓	○	○
	1.5	P MI 00018 150	✓	✓	✓	✓	○	✓	○	○
	1	P MI 00018 100	✓	✓	✓	✓	○	✓	○	○

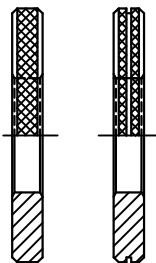
Specification: ISO 965, ISO 1502/ DIN 13



✓ Available in stock ○ Manufactured against order

All the Sizes & Tolerances specified in DIN / ISO are covered in our manufacturing program. PRICES ON REQUEST

Size			Catalogue Code	Go Ring	Nogo Ring	Go Ring	Nogo Ring	Go Ring	Nogo Ring
Diameter	Pitch	6g RH		6g RH	6e RH	6e RH	6h RH	6h RH	
			6G GR	6G NR	6E GR	6E NR	6H GR	6H NR	
M2.5	0.35	R MI 00025 035	✓	✓	○	○	○	○	
M3	0.35	R MI 00003 035	○	○	○	○	○	○	
M4	0.5	R MI 00004 050	✓	✓	✓	✓	✓	✓	
M5	0.75	R MI 00005 075	✓	✓	✓	✓	✓	✓	
	0.5	R MI 00005 050	✓	✓	○	○	○	○	
M6	0.75	R MI 00006 075	✓	✓	○	○	○	○	
	0.5	R MI 00006 050	✓	✓	○	○	○	○	
M7	0.75	R MI 00007 075	✓	✓	○	○	○	○	
	0.5	R MI 00007 050	○	○	○	○	○	○	
M8	1	R MI 00008 100	✓	✓	✓	✓	✓	✓	
	0.75	R MI 00008 075	✓	✓	○	○	○	○	
	0.5	R MI 00008 050	✓	✓	○	○	○	○	
M9	1	R MI 00009 100	✓	✓	○	○	○	○	
	0.75	R MI 00009 075	✓	✓	○	○	○	○	
	0.5	R MI 00009 050	○	○	○	○	○	○	
M10	1.25	R MI 00010 125	✓	✓	✓	✓	✓	✓	
	1	R MI 00010 100	✓	✓	✓	✓	✓	✓	
	0.75	R MI 00010 075	✓	✓	○	○	○	○	
	0.5	R MI 00010 050	✓	✓	○	○	○	○	
M11	1	R MI 00011 100	✓	✓	✓	✓	✓	✓	
	M12	1.5	R MI 00012 150	✓	✓	✓	✓	✓	✓
1.25		R MI 00012 125	✓	✓	✓	✓	✓	✓	
1		R MI 00012 100	✓	✓	✓	✓	○	○	
0.75		R MI 00012 075	✓	✓	○	○	○	○	
M14	0.5	R MI 00012 050	○	○	○	○	○	○	
	1.5	R MI 00014 150	✓	✓	✓	✓	✓	✓	
	1.25	R MI 00014 125	✓	✓	✓	✓	✓	✓	
	1	R MI 00014 100	✓	✓	✓	✓	○	○	
M15	0.75	R MI 00014 075	✓	✓	✓	✓	✓	✓	
	1	R MI 00015 100	✓	✓	○	○	○	○	
	M16	1.5	R MI 00016 150	✓	✓	✓	✓	✓	✓
1.25		R MI 00016 125	✓	✓	✓	✓	✓	✓	
1		R MI 00016 100	✓	✓	✓	✓	✓	✓	
0.75		R MI 00016 075	✓	✓	○	○	○	○	
M17	1	R MI 00017 100	✓	✓	○	○	○	○	
M18	2	R MI 00018 200	✓	✓	✓	✓	✓	✓	
	1.5	R MI 00018 150	✓	✓	✓	✓	✓	✓	
	1	R MI 00018 100	✓	✓	✓	✓	✓	✓	



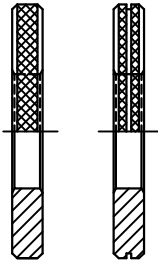

✓ Available in stock    ○ Manufactured against order

 All the Sizes & Tolerances specified in DIN / ISO are covered in our manufacturing program. **PRICES ON REQUEST**

Size			Catalogue Code	Go Ring	Nogo Ring	Go Ring	Nogo Ring	Go Ring	Nogo Ring
Diameter	Pitch	6g LH		6g LH	6e LH	6e LH	6h LH	6h LH	
		6G GL		6G NL	6E GL	6E NL	6H GL	6H NL	
M2.5	0.35	R MI 00025 035	○	○	○	○	○	○	
M3	0.35	R MI 00003 035	✓	✓	○	○	○	○	
M4	0.5	R MI 00004 050	✓	✓	○	○	○	○	
M5	0.75	R MI 00005 075	✓	✓	○	○	○	○	
	0.5	R MI 00005 050	✓	✓	○	○	○	○	
M6	0.75	R MI 00006 075	✓	✓	○	○	○	○	
	0.5	R MI 00006 050	✓	✓	○	○	○	○	
M7	0.75	R MI 00007 075	✓	✓	○	○	○	○	
	0.5	R MI 00007 050	○	○	○	○	○	○	
M8	1	R MI 00008 100	✓	✓	✓	✓	✓	✓	
	0.75	R MI 00008 075	✓	✓	○	○	○	○	
	0.5	R MI 00008 050	✓	✓	○	○	○	○	
M9	1	R MI 00009 100	✓	✓	○	○	○	○	
	0.75	R MI 00009 075	✓	✓	○	○	○	○	
	0.5	R MI 00009 050	○	○	○	○	○	○	
M10	1.25	R MI 00010 125	✓	✓	✓	✓	✓	✓	
	1	R MI 00010 100	✓	✓	○	○	○	○	
	0.75	R MI 00010 075	✓	✓	○	○	○	○	
	0.5	R MI 00010 050	✓	✓	○	○	○	○	
M11	1	R MI 00011 100	✓	✓	○	○	○	○	
	M12	1.5	R MI 00012 150	✓	✓	✓	✓	✓	✓
1.25		R MI 00012 125	✓	✓	✓	✓	✓	✓	
1		R MI 00012 100	✓	✓	○	○	○	○	
0.75		R MI 00012 075	○	○	○	○	○	○	
0.5		R MI 00012 050	○	○	○	○	○	○	
M14	1.5	R MI 00014 150	✓	✓	✓	✓	✓	✓	
	1.25	R MI 00014 125	✓	✓	✓	✓	✓	✓	
	1	R MI 00014 100	✓	✓	○	✓	○	○	
	0.75	R MI 00014 075	✓	✓	○	○	○	○	
M15	1	R MI 00015 100	✓	✓	○	○	○	○	
M16	1.5	R MI 00016 150	✓	✓	✓	✓	✓	✓	
	1.25	R MI 00016 125	✓	✓	○	○	○	○	
	1	R MI 00016 100	✓	✓	○	○	○	○	
	0.75	R MI 00016 075	✓	✓	○	○	○	○	
M17	1	R MI 00017 100	✓	✓	○	○	○	○	
M18	2	R MI 00018 200	✓	✓	○	○	○	○	
	1.5	R MI 00018 150	✓	✓	○	○	○	○	
	1	R MI 00018 100	✓	✓	○	○	○	○	



Specification: ISO 965, ISO 1502/ DIN 13

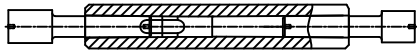

✓ Available in stock ○ Manufactured against order

All the Sizes & Tolerances specified in DIN / ISO are covered in our manufacturing program. PRICES ON REQUEST

Size											Go & Nogo Plain Plug to check Minor Dia.	
			Go & Nogo Plug	Go & Nogo Plug	Go & Nogo Plug	Go & Nogo Plug	Go & Nogo Plug	Go & Nogo Plug	6H	6G		
			Diameter	Pitch	Catalogue Code	6H RH	4H RH	6G RH	6H LH	4H LH	6G LH	6H D0
M20	2	P MI 00020 200	✓	○	✓	✓	○	○	✓	○		
	1.5	P MI 00020 150	✓	○	✓	✓	○	○	✓	○		
	1	P MI 00020 100	✓	○	✓	✓	○	○	✓	○		
M22	2	P MI 00022 200	✓	○	✓	✓	○	○	✓	○		
	1.5	P MI 00022 150	✓	○	✓	✓	○	○	✓	○		
	1	P MI 00022 100	✓	○	✓	✓	○	○	✓	○		
M24	2	P MI 00024 200	✓	○	✓	✓	○	○	✓	○		
	1.5	P MI 00024 150	✓	○	✓	✓	○	○	✓	○		
	1	P MI 00024 100	✓	○	✓	✓	○	○	○	○		
M25	1.5	P MI 00025 150	✓	○	✓	✓	○	○	○	○		
	1	P MI 00025 100	✓	○	✓	✓	○	○	○	○		
M26	1	P MI 00026 100	✓	○	✓	✓	○	○	○	○		
M27	2	P MI 00027 200	✓	○	✓	✓	○	○	○	○		
	1.5	P MI 00027 150	✓	○	✓	✓	○	○	○	○		
	1	P MI 00027 100	✓	○	✓	✓	○	○	○	○		
M28	1.5	P MI 00028 150	✓	○	✓	✓	○	○	○	○		
	1	P MI 00028 100	✓	○	✓	✓	○	○	○	○		
M30	3	P MI 00030 300	✓	○	✓	✓	○	○	○	○		
	2	P MI 00030 200	✓	○	✓	✓	○	○	○	○		
	1.5	P MI 00030 150	✓	○	✓	✓	○	○	○	○		
M32	1	P MI 00030 100	✓	○	✓	✓	○	○	○	○		
	1.5	P MI 00032 150	✓	○	✓	✓	○	○	○	○		
	1	P MI 00032 100	✓	○	✓	✓	○	○	○	○		
M33	3	P MI 00033 300	✓	○	✓	✓	○	○	○	○		
	2	P MI 00033 200	✓	○	✓	✓	○	○	○	○		
	1.5	P MI 00033 150	✓	○	✓	✓	○	○	○	○		
M35	1	P MI 00035 100	✓	○	✓	✓	○	○	○	○		
M36	3	P MI 00036 300	✓	○	✓	✓	○	○	○	○		
	2	P MI 00036 200	✓	○	✓	✓	○	○	○	○		
	1.5	P MI 00036 150	✓	○	✓	✓	○	○	○	○		
M38	1	P MI 00036 100	✓	○	✓	✓	○	○	○	○		
	1	P MI 00038 100	✓	○	✓	✓	○	○	○	○		
	3	P MI 00039 300	✓	○	✓	✓	○	○	○	○		
M39	2	P MI 00039 200	✓	○	✓	✓	○	○	○	○		
	1.5	P MI 00039 150	✓	○	✓	✓	○	○	○	○		
M40	2	P MI 00040 200	✓	○	✓	✓	○	○	○	○		
	1.5	P MI 00040 150	✓	○	✓	✓	○	○	○	○		
	1	P MI 00040 100	✓	○	✓	✓	○	○	○	○		



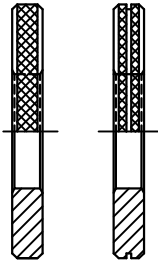

✓ Available in stock    ○ Manufactured against order

 All the Sizes & Tolerances specified in DIN / ISO are covered in our manufacturing program. **PRICES ON REQUEST**

Size			Catalogue Code	Go Ring	Nogo Ring	Go Ring	Nogo Ring	Go Ring	Nogo Ring
Diameter	Pitch	6g RH		6g RH	6e RH	6e RH	6h RH	6h RH	
			6G GR	6G NR	6E GR	6E NR	6H GR	6H NR	
M20	2	R MI 00020 200	✓	✓	✓	✓	✓	✓	
	1.5	R MI 00020 150	✓	✓	✓	✓	✓	✓	
	1	R MI 00020 100	✓	✓	✓	✓	✓	✓	
M22	2	R MI 00022 200	✓	✓	✓	✓	✓	✓	
	1.5	R MI 00022 150	✓	✓	✓	✓	✓	✓	
	1	R MI 00022 100	✓	✓	✓	✓	✓	✓	
M24	2	R MI 00024 200	✓	✓	✓	✓	✓	✓	
	1.5	R MI 00024 150	✓	✓	✓	✓	✓	✓	
	1	R MI 00024 100	✓	✓	✓	✓	✓	✓	
M25	1.5	R MI 00025 150	✓	✓	✓	✓	✓	✓	
	1	R MI 00025 100	✓	✓	✓	✓	✓	✓	
M26	1	R MI 00026 100	✓	✓	✓	✓	○	○	
M27	2	R MI 00027 200	✓	✓	○	○	○	○	
	1.5	R MI 00027 150	✓	✓	○	○	○	○	
	1	R MI 00027 100	✓	✓	○	○	○	○	
M28	1.5	R MI 00028 150	✓	✓	○	○	○	○	
	1	R MI 00028 100	✓	✓	○	○	○	○	
M30	3	R MI 00030 300	✓	✓	○	○	○	○	
	2	R MI 00030 200	✓	✓	○	○	○	○	
	1.5	R MI 00030 150	✓	✓	○	○	○	○	
M32	1	R MI 00030 100	✓	✓	○	○	○	○	
	1.5	R MI 00032 150	✓	✓	○	○	○	○	
	1	R MI 00032 100	✓	✓	○	○	○	○	
M33	3	R MI 00033 300	✓	✓	○	○	○	○	
	2	R MI 00033 200	✓	✓	○	○	○	○	
	1.5	R MI 00033 150	✓	✓	○	○	○	○	
M35	1	R MI 00035 100	✓	✓	○	○	○	○	
M36	3	R MI 00036 300	✓	✓	○	○	○	○	
	2	R MI 00036 200	✓	✓	○	○	○	○	
	1.5	R MI 00036 150	✓	✓	○	○	○	○	
M38	1	R MI 00036 100	✓	✓	○	○	○	○	
	1	R MI 00038 100	✓	✓	○	○	○	○	
	1	R MI 00038 100	✓	✓	○	○	○	○	
M39	3	R MI 00039 300	✓	✓	○	○	○	○	
	2	R MI 00039 200	✓	✓	○	○	○	○	
	1.5	R MI 00039 150	✓	✓	○	○	○	○	
M40	2	R MI 00040 200	✓	✓	○	○	○	○	
	1.5	R MI 00040 150	✓	✓	○	○	○	○	
	1	R MI 00040 100	✓	✓	○	○	○	○	



Specification: ISO 965, ISO 1502/ DIN 13

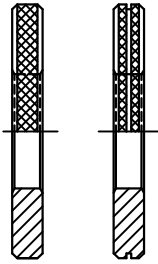

✓ Available in stock ○ Manufactured against order

All the Sizes & Tolerances specified in DIN / ISO are covered in our manufacturing program. PRICES ON REQUEST

Size			Catalogue Code	Go Ring	Nogo Ring	Go Ring	Nogo Ring	Go Ring	Nogo Ring
Diameter	Pitch	6g LH		6g LH	6e LH	6e LH	6h LH	6h LH	
			6G GL	6G NL	6E GL	6E NL	6H GL	6H NL	
M20	2		R MI 00020 200	✓	✓	○	○	○	○
	1.5		R MI 00020 150	✓	✓	○	○	○	○
	1		R MI 00020 100	✓	✓	○	○	○	○
M22	2		R MI 00022 200	✓	✓	○	○	○	○
	1.5		R MI 00022 150	✓	✓	○	○	○	○
	1		R MI 00022 100	✓	✓	○	○	○	○
M24	2		R MI 00024 200	✓	✓	○	○	○	○
	1.5		R MI 00024 150	✓	✓	○	○	○	○
	1		R MI 00024 100	✓	✓	○	○	○	○
M25	1.5		R MI 00025 150	✓	✓	○	○	○	○
	1		R MI 00025 100	✓	✓	○	○	○	○
M26	1		R MI 00026 100	✓	✓	○	○	○	○
M27	2		R MI 00027 200	✓	✓	○	○	○	○
	1.5		R MI 00027 150	✓	✓	○	○	○	○
	1		R MI 00027 100	✓	✓	○	○	○	○
M28	1.5		R MI 00028 150	✓	✓	○	○	○	○
	1		R MI 00028 100	✓	✓	○	○	○	○
M30	3		R MI 00030 300	✓	✓	○	○	○	○
	2		R MI 00030 200	✓	✓	○	○	○	○
	1.5		R MI 00030 150	✓	✓	○	○	○	○
	1		R MI 00030 100	✓	✓	○	○	○	○
M32	1.5		R MI 00032 150	✓	✓	○	○	○	○
	1		R MI 00032 100	✓	✓	○	○	○	○
M33	3		R MI 00033 300	✓	✓	○	○	○	○
	2		R MI 00033 200	✓	✓	○	○	○	○
	1.5		R MI 00033 150	✓	✓	○	○	○	○
M35	1		R MI 00035 100	✓	✓	○	○	○	○
M36	3		R MI 00036 300	✓	✓	○	○	○	○
	2		R MI 00036 200	✓	✓	○	○	○	○
	1.5		R MI 00036 150	✓	✓	○	○	○	○
	1		R MI 00036 100	✓	✓	○	○	○	○
M38	1		R MI 00038 100	✓	✓	○	○	○	○
M39	3		R MI 00039 300	✓	✓	○	○	○	○
	2		R MI 00039 200	✓	✓	○	○	○	○
	1.5		R MI 00039 150	✓	✓	○	○	○	○
M40	2		R MI 00040 200	✓	✓	○	○	○	○
	1.5		R MI 00040 150	✓	✓	○	○	○	○
	1		R MI 00040 100	✓	✓	○	○	○	○



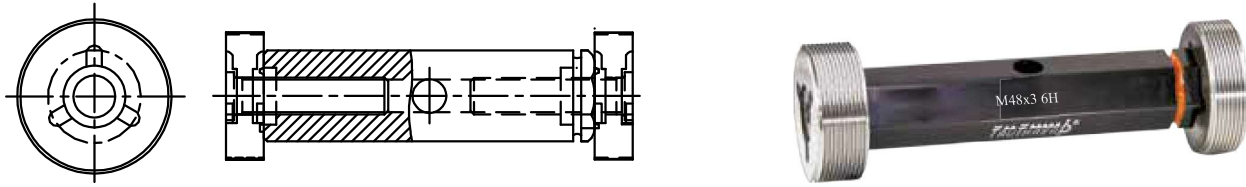

 All the Sizes & Tolerances specified in DIN / ISO are covered in our manufacturing program. **PRICES ON REQUEST**

✓ Available in stock    ○ Manufactured against order

Size		atalogue Code						
Diameter	Pitch		Go & Nogo Plug	Go & Nogo Plug	Go & Nogo Plug	Go & Nogo Plug	Go & Nogo Plug	Go & Nogo Plug
			6H RH	4H RH	6G RH	6H LH	4H LH	6G LH
			6H DR	4H DR	6G DR	6H DL	4H DL	6G DL
M42	4	P MI 00042 400	✓	○	○	○	○	○
	3	P MI 00042 300	✓	○	○	○	○	○
	2	P MI 00042 200	✓	○	○	○	○	○
	1.5	P MI 00042 150	✓	○	○	○	○	○
	1	P MI 00042 100	✓	○	○	○	○	○
M45	4	P MI 00045 400	✓	○	○	○	○	○
	3	P MI 00045 300	✓	○	○	○	○	○
	2	P MI 00045 200	✓	○	○	○	○	○
	1.5	P MI 00045 150	✓	○	○	○	○	○
	1	P MI 00045 100	✓	○	○	○	○	○
M48	4	P MI 00048 400	✓	○	○	○	○	○
	3	P MI 00048 300	✓	○	○	○	○	○
	2	P MI 00048 200	✓	○	○	○	○	○
	1.5	P MI 00048 150	✓	○	○	○	○	○
	1	P MI 00048 100	✓	○	○	○	○	○
M50	2	P MI 00050 200	✓	○	○	○	○	○
	1.5	P MI 00050 150	✓	○	○	○	○	○
	1	P MI 00050 100	✓	○	○	○	○	○
M52	4	P MI 00052 400	✓	○	○	○	○	○
	3	P MI 00052 300	✓	○	○	○	○	○
	2	P MI 00052 200	✓	○	○	○	○	○
	1.5	P MI 00052 150	✓	○	○	○	○	○
M55	4	P MI 00055 400	✓	○	○	○	○	○
	3	P MI 00055 300	✓	○	○	○	○	○
	2	P MI 00055 200	✓	○	○	○	○	○
	1.5	P MI 00055 150	✓	○	○	○	○	○
M56	4	P MI 00056 400	✓	○	○	○	○	○
	3	P MI 00056 300	✓	○	○	○	○	○
	2	P MI 00056 200	✓	○	○	○	○	○
M58	1.5	P MI 00056 150	✓	○	○	○	○	○
	3	P MI 00058 300	✓	○	○	○	○	○
	2	P MI 00058 200	✓	○	○	○	○	○
M60	1.5	P MI 00058 150	✓	○	○	○	○	○
	4	P MI 00060 400	✓	○	○	○	○	○
	3	P MI 00060 300	✓	○	○	○	○	○
M60	2	P MI 00060 200	✓	○	○	○	○	○
	1.5	P MI 00060 150	✓	○	○	○	○	○

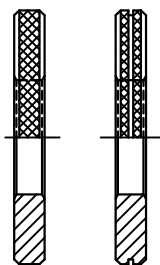

Specification: ISO 965, ISO 1502/ DIN 13



✓ Available in stock ○ Manufactured against order

Size		Catalogue Code	Go Ring	Nogo Ring	Go Ring	Nogo Ring	Go Ring	Nogo Ring
Diameter	Pitch		6g RH	6g RH	6h RH	6h RH	6g LH	6g LH
			6G GR	6G NR	6H GR	6H NR	6G GL	6G NL
M42	4	R MI 00042 400	✓	✓	○	○	○	○
	3	R MI 00042 300	✓	✓	○	○	○	○
	2	R MI 00042 200	✓	✓	○	○	○	○
	1.5	R MI 00042 150	✓	✓	○	○	○	○
	1	R MI 00042 100	✓	✓	○	○	○	○
M45	4	R MI 00045 400	✓	✓	○	○	○	○
	3	R MI 00045 300	✓	✓	○	○	○	○
	2	R MI 00045 200	✓	✓	○	○	○	○
	1.5	R MI 00045 150	✓	✓	○	○	○	○
	1	R MI 00045 100	✓	✓	○	○	○	○
M48	4	R MI 00048 400	✓	✓	○	○	○	○
	3	R MI 00048 300	✓	✓	○	○	○	○
	2	R MI 00048 200	✓	✓	○	○	○	○
	1.5	R MI 00048 150	✓	✓	○	○	○	○
	1	R MI 00048 100	✓	✓	○	○	○	○
M50	2	R MI 00050 200	✓	✓	○	○	○	○
	1.5	R MI 00050 150	✓	✓	○	○	○	○
	1	R MI 00050 100	✓	✓	○	○	○	○
M52	4	R MI 00052 400	✓	✓	○	○	○	○
	3	R MI 00052 300	✓	✓	○	○	○	○
	2	R MI 00052 200	✓	✓	○	○	○	○
	1.5	R MI 00052 150	✓	✓	○	○	○	○
M55	4	R MI 00055 400	✓	✓	○	○	○	○
	3	R MI 00055 300	✓	✓	○	○	○	○
	2	R MI 00055 200	✓	✓	○	○	○	○
	1.5	R MI 00055 150	✓	✓	○	○	○	○
M56	4	R MI 00056 400	✓	✓	○	○	○	○
	3	R MI 00056 300	✓	✓	○	○	○	○
	2	R MI 00056 200	✓	✓	○	○	○	○
	1.5	R MI 00056 150	✓	✓	○	○	○	○
M58	3	R MI 00058 300	✓	✓	○	○	○	○
	2	R MI 00058 200	✓	✓	○	○	○	○
	1.5	R MI 00058 150	✓	✓	○	○	○	○
M60	4	R MI 00060 400	✓	✓	○	○	○	○
	3	R MI 00060 300	✓	✓	○	○	○	○
	2	R MI 00060 200	✓	✓	○	○	○	○
	1.5	R MI 00060 150	✓	✓	○	○	○	○

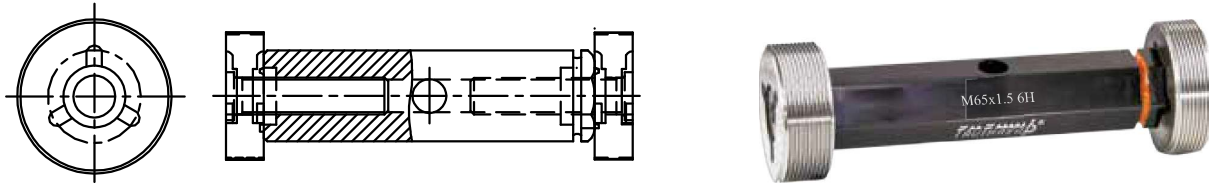

All the Sizes & Tolerances specified in DIN / ISO are covered in our manufacturing program. PRICES ON REQUEST

 All the Sizes & Tolerances specified in DIN / ISO are covered in our manufacturing program. **PRICES ON REQUEST**

Available in stock    Manufactured against order

Size		Catalogue Code						
Diameter	Pitch		Go & Nogo Plug 6H RH	Go & Nogo Plug 4H RH	Go & Nogo Plug 6G RH	Go & Nogo Plug 6H LH	Go & Nogo Plug 4H LH	Go & Nogo Plug 6G LH
			6H DR	4H DR	6G DR	6H DL	4H DL	6G DL
<b>M62</b>	3	P MI 00062 300	✓	○	○	○	○	○
	2	P MI 00062 200	✓	○	○	○	○	○
<b>M64</b>	1.5	P MI 00062 150	✓	○	○	○	○	○
	4	R MI 00064 400	✓	○	○	○	○	○
	3	R MI 00064 300	✓	○	○	○	○	○
<b>M65</b>	2	R MI 00064 200	✓	○	○	○	○	○
	1.5	R MI 00064 150	✓	○	○	○	○	○
	3	R MI 00065 300	✓	○	○	○	○	○
<b>M65</b>	2	R MI 00065 200	✓	○	○	○	○	○
	1.5	R MI 00065 150	✓	○	○	○	○	○



Above 65 mm mm Diameter Go & Nogo Plugs are supplied separately.

Available in stock    Manufactured against order

Size		Catalogue Code						
Diameter	Pitch		Go Plug 6H RH	Nogo Plug 6H RH	Go Plug 6G RH	Nogo Plug 6G RH	Go Plug 6H LH	Nogo Plug 6H LH
			6H GR	6H NR	6G GR	6G NR	6H GL	6H NL
<b>M68</b>	4	P MI 00068 400	✓	✓	○	○	○	○
	3	P MI 00068 300	✓	✓	○	○	○	○
	2	P MI 00068 200	✓	✓	○	○	○	○
<b>M70</b>	1.5	P MI 00068 150	✓	✓	○	○	○	○
	6	P MI 00070 600	○	○	○	○	○	○
	4	P MI 00070 400	✓	✓	○	○	○	○
<b>M72</b>	3	P MI 00070 300	✓	✓	○	○	○	○
	2	P MI 00070 200	✓	✓	○	○	○	○
	1.5	P MI 00070 150	✓	✓	○	○	○	○
<b>M75</b>	6	P MI 00072 600	✓	✓	○	○	○	○
	4	P MI 00072 400	○	○	○	○	○	○
	3	P MI 00072 300	✓	✓	○	○	○	○
<b>M75</b>	2	P MI 00072 200	✓	✓	○	○	○	○
	1.5	P MI 00072 150	✓	✓	○	○	○	○
	4	P MI 00075 400	○	○	○	○	○	○
<b>M75</b>	3	P MI 00075 300	✓	✓	○	○	○	○
	2	P MI 00075 200	✓	✓	○	○	○	○
	1.5	P MI 00075 150	✓	✓	○	○	○	○



Specification: ISO 965, ISO 1502/ DIN 13

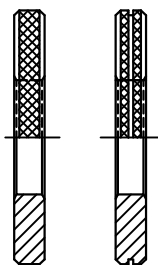

All the Sizes & Tolerances specified in DIN / ISO are covered in our manufacturing program. PRICES ON REQUEST

✓ Available in stock   ○ Manufactured against order

Size			Right Hand Thread				Left Hand Thread	
			Go Ring 6g RH	Nogo Ring 6g RH	Go Ring 6h RH	Nogo Ring 6h RH	Go Ring 6g LH	Nogo Ring 6g LH
Diameter	Pitch	Catalogue Code	6G GR	6G NR	6H GR	6H NR	6G GL	6G NL
M62	3	R MI 00062 300	✓	✓	○	○	○	○
	2	R MI 00062 200	✓	✓	○	○	○	○
	1.5	R MI 00062 150	✓	✓	○	○	○	○
M64	4	R MI 00064 400	✓	✓	○	○	○	○
	3	R MI 00064 300	✓	✓	○	○	○	○
	2	R MI 00064 200	✓	✓	○	○	○	○
M65	1.5	R MI 00064 150	✓	✓	○	○	○	○
	3	R MI 00065 300	✓	✓	○	○	○	○
	2	R MI 00065 200	✓	✓	○	○	○	○
M68	1.5	R MI 00065 150	✓	✓	○	○	○	○
	4	R MI 00068 400	○	○	○	○	○	○
	3	R MI 00068 300	○	○	○	○	○	○
M70	2	R MI 00068 200	○	○	○	○	○	○
	1.5	R MI 00068 150	○	○	○	○	○	○
	6	R MI 00070 600	○	○	○	○	○	○
M72	4	R MI 00070 400	○	○	○	○	○	○
	3	R MI 00070 300	✓	✓	○	○	○	○
	2	R MI 00070 200	✓	✓	○	○	○	○
	1.5	R MI 00070 150	✓	✓	○	○	○	○
M75	6	R MI 00072 600	○	○	○	○	○	○
	4	R MI 00072 400	○	○	○	○	○	○
	3	R MI 00072 300	✓	✓	○	○	○	○
	2	R MI 00072 200	✓	✓	○	○	○	○
M75	1.5	R MI 00072 150	✓	✓	○	○	○	○
	4	R MI 00075 400	✓	✓	○	○	○	○
	3	R MI 00075 300	✓	✓	○	○	○	○
M75	2	R MI 00075 200	✓	✓	○	○	○	○
	1.5	R MI 00075 150	✓	✓	○	○	○	○



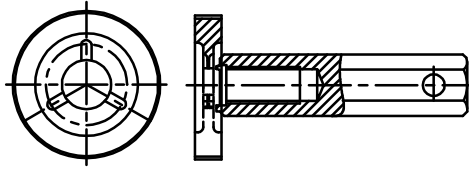

 All the Sizes & Tolerances specified in DIN / ISO are covered in our manufacturing program. **PRICES ON REQUEST**

✓ Available in stock    ○ Manufactured against order

Size								
			Go Plug 6H RH	Nogo Plug 6H RH	Go Plug 6G RH	Nogo Plug 6G RH	Go Plug 6H LH	Nogo Plug 6H LH
Diameter	Pitch	Catalogue Code	6H GR	6H NR	6G GR	6G NR	6H GL	6H NL
<b>M76</b>	6	P MI 00076 600	○	○	○	○	○	○
	4	P MI 00076 400	✓	✓	○	○	○	○
	3	P MI 00076 300	✓	✓	○	○	○	○
	2	P MI 00076 200	✓	✓	○	○	○	○
	1.5	P MI 00076 150	○	○	○	○	○	○
<b>M78</b>	2	P MI 00078 200	○	○	○	○	○	○
	1.5	P MI 00078 150	○	○	○	○	○	○
<b>M80</b>	6	P MI 00080 600	✓	✓	○	○	○	○
	4	P MI 00080 400	✓	✓	○	○	○	○
	3	P MI 00080 300	✓	✓	○	○	○	○
	2	P MI 00080 200	✓	✓	○	○	○	○
	1.5	P MI 00080 150	✓	✓	○	○	○	○
<b>M82</b>	2	P MI 00082 200	○	○	○	○	○	○
	1.5	P MI 00082 150	○	○	○	○	○	○
<b>M85</b>	6	P MI 00085 600	○	○	○	○	○	○
	4	P MI 00085 400	✓	✓	○	○	○	○
	3	P MI 00085 300	✓	✓	○	○	○	○
	2	P MI 00085 200	✓	✓	○	○	○	○
	1.5	P MI 00085 150	✓	✓	○	○	○	○
<b>M90</b>	6	P MI 00090 600	○	○	○	○	○	○
	4	P MI 00090 400	○	○	○	○	○	○
	3	P MI 00090 300	✓	✓	○	○	○	○
	2	P MI 00090 200	✓	✓	○	○	○	○
	1.5	P MI 00090 150	✓	✓	○	○	○	○
<b>M95</b>	6	P MI 00095 600	○	○	○	○	○	○
	4	P MI 00095 400	○	○	○	○	○	○
	3	P MI 00095 300	✓	✓	○	○	○	○
	2	P MI 00095 200	✓	✓	○	○	○	○
	1.5	P MI 00095 150	✓	✓	○	○	○	○
<b>M100</b>	6	P MI 00100 600	✓	✓	○	○	○	○
	4	P MI 00100 400	✓	✓	○	○	○	○
	3	P MI 00100 300	✓	✓	○	○	○	○
	2	P MI 00100 200	✓	✓	○	○	○	○
	1.5	P MI 00100 150	✓	✓	○	○	○	○

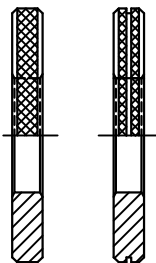

Specification: ISO 965, ISO 1502/ DIN 13



All the Sizes & Tolerances specified in DIN / ISO are covered in our manufacturing program. PRICES ON REQUEST

✓ Available in stock    ○ Manufactured against order

Size		Catalogue Code						
Diameter	Pitch		Go Ring	Nogo Ring	Go Ring	Nogo Ring	Go Ring	Nogo Ring
			6g RH	6g RH	6h RH	6h RH	6g LH	6g LH
M76	6	R MI 00076 600	✓	✓	○	○	○	○
	4	R MI 00076 400	✓	✓	○	○	○	○
	3	R MI 00076 300	✓	✓	○	○	○	○
	2	R MI 00076 200	✓	✓	○	○	○	○
	1.5	R MI 00076 150	✓	✓	○	○	○	○
M78	2	R MI 00078 200	✓	✓	○	○	○	○
	1.5	R MI 00078 150	✓	✓	○	○	○	○
M80	6	R MI 00080 600	✓	✓	○	○	○	○
	4	R MI 00080 400	✓	✓	○	○	○	○
	3	R MI 00080 300	✓	✓	○	○	○	○
	2	R MI 00080 200	✓	✓	○	○	○	○
	1.5	R MI 00080 150	✓	✓	○	○	○	○
M82	2	R MI 00082 200	✓	✓	○	○	○	○
	1.5	R MI 00082 150	✓	✓	○	○	○	○
M85	6	R MI 00085 600	○	○	○	○	○	○
	4	R MI 00085 400	✓	✓	○	○	○	○
	3	R MI 00085 300	✓	✓	○	○	○	○
	2	R MI 00085 200	✓	✓	○	○	○	○
	1.5	R MI 00085 150	✓	✓	○	○	○	○
M90	6	R MI 00090 600	○	○	○	○	○	○
	4	R MI 00090 400	✓	✓	○	○	○	○
	3	R MI 00090 300	✓	✓	○	○	○	○
	2	R MI 00090 200	✓	✓	○	○	○	○
	1.5	R MI 00090 150	✓	✓	○	○	○	○
M95	6	R MI 00095 600	○	○	○	○	○	○
	4	R MI 00095 400	○	○	○	○	○	○
	3	R MI 00095 300	✓	✓	○	○	○	○
	2	R MI 00095 200	✓	✓	○	○	○	○
	1.5	R MI 00095 150	✓	✓	○	○	○	○
M100	6	R MI 00100 600	✓	✓	○	○	○	○
	4	R MI 00100 400	✓	✓	○	○	○	○
	3	R MI 00100 300	✓	✓	○	○	○	○
	2	R MI 00100 200	✓	✓	○	○	○	○
	1.5	R MI 00100 150	✓	✓	○	○	○	○





Specification: ISO 5855/ISO 1095  
ANSI B1.21 M

Application: In Aeronautical Industry, Metric / SI units.

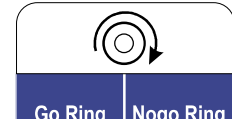
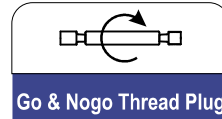

✓ Available in stock ○ Manufactured against order

All the Sizes & Tolerances specified in DIN / ISO are covered in our manufacturing program. PRICES ON REQUEST

Size			Go & Nogo Thread Plug		Size			Go Ring / Nogo Ring	
Diameter	Pitch	Catalogue Code	4H6H RH	4H5H RH	Diameter	Pitch	Catalogue Code	4h6h RH	4h6h RH
			6H DR	5H DR				6H GR	6H NR
MJ 3	0.5	P MJ 00003 050	✓	N/A	MJ 3	0.5	R MJ 00003 050	✓	✓
MJ 3.5	0.6	P MJ 00035 060	○	N/A	MJ 3.5	0.6	R MJ 00035 060	○	○
MJ 4	0.7	P MJ 00004 070	✓	N/A	MJ 4	0.7	R MJ 00004 070	✓	✓
MJ 4.5	0.75	P MJ 00045 075	○	N/A	MJ 4.5	0.75	R MJ 00045 075	○	○
MJ 5	0.8	P MJ 00005 080	✓	N/A	MJ 5	0.8	R MJ 00005 080	✓	✓
MJ 6	1	P MJ 00006 100	NA	✓	MJ 6	1	R MJ 00006 100	✓	✓
	0.75	P MJ 00006 075	NA	✓		0.75	R MJ 00006 075	✓	✓
MJ 7	1	P MJ 00007 100	NA	✓	MJ 7	1	R MJ 00007 100	✓	✓
MJ 8	1.25	P MJ 00008 125	NA	✓	MJ 8	1.25	R MJ 00008 125	✓	✓
	1	P MJ 00008 100	NA	✓		1	R MJ 00008 100	✓	✓
MJ 9	1.25	P MJ 00009 125	NA	✓	MJ 9	1.25	R MJ 00009 125	✓	✓
	1	P MJ 00009 100	NA	✓		1	R MJ 00009 100	✓	✓
MJ 10	1.5	P MJ 00010 150	NA	✓	MJ 10	1.5	R MJ 00010 150	✓	✓
	1.25	P MJ 00010 125	NA	✓		1.25	R MJ 00010 125	✓	✓
	1	P MJ 00010 100	NA	✓		1	R MJ 00010 100	✓	✓
MJ 12	1.75	P MJ 00012 175	NA	✓	MJ 12	1.75	R MJ 00012 175	✓	✓
MJ 14	2	P MJ 00014 200	NA	✓	MJ 14	2	R MJ 00014 200	✓	✓
	1.5	P MJ 00014 150	NA	✓		1.5	R MJ 00014 150	✓	✓
	1.25	P MJ 00014 125	NA	✓		1.25	R MJ 00014 125	✓	✓
	1	P MJ 00014 100	NA	✓		1	R MJ 00014 100	✓	✓
MJ 16	2	P MJ 00016 200	NA	✓	MJ 16	2	R MJ 00016 200	✓	✓
	1.5	P MJ 00016 150	NA	✓		1.5	R MJ 00016 150	✓	✓
	1.25	P MJ 00016 125	NA	✓		1.25	R MJ 00016 125	✓	✓
	1	P MJ 00016 100	NA	✓		1	R MJ 00016 100	✓	✓
MJ 18	2.50	P MJ 00018 250	NA	✓	MJ 18	2.50	R MJ 00018 250	✓	✓
	2	P MJ 00018 200	NA	✓		2	R MJ 00018 200	✓	✓
	1.5	P MJ 00018 150	NA	✓		1.5	R MJ 00018 150	✓	✓
MJ 20	2.50	P MJ 00020 250	NA	✓	MJ 20	2.50	R MJ 00020 250	✓	✓
	2	P MJ 00020 200	NA	✓		2	R MJ 00020 200	✓	✓
	1.5	P MJ 00020 150	NA	✓		1.5	R MJ 00020 150	✓	✓
MJ 22	2.50	P MJ 00022 250	NA	○	MJ 22	2.50	R MJ 00022 250	○	○
	2	P MJ 00022 200	NA	○		2	R MJ 00022 200	○	○
	1.5	P MJ 00022 150	NA	○		1.5	R MJ 00022 150	○	○
MJ 24	3	P MJ 00024 300	NA	○	MJ 24	3	R MJ 00024 300	○	○
	2	P MJ 00024 200	NA	○		2	R MJ 00024 200	○	○
	1.5	P MJ 00024 150	NA	○		1.5	R MJ 00024 150	○	○
MJ 25	3	P MJ 00025 300	NA	○	MJ 25	3	R MJ 00025 300	○	○
	1.5	P MJ 00025 150	NA	○		1.5	R MJ 00025 150	○	○

NA - Not Applicable

Specification: BS 4377 / DIN 8140



**Application:** To check tapped holes to receive wire thread inserts.



These gauges are used for checking oversize tapping which is done for fitting wire thread inserts. Wire thread inserts are having external threads which are oversize than the standard size and internal threads which are of standard dimensions. When tapped internal threads become oversize and standard screw cannot be fitted then wire threads inserts are used. Oversize tapping is done using wire thread taps and wire thread inserts are fitted in this.

These are also known as Heli-coil thread inserts. 'Heli-coil' is a registered Trade mark of Emhart Technologies, USA.

**TOLERANCE CLASS :**

5H and 6H classes are recommended for Metric threads.

All the Sizes & Tolerances not covered in catalogue are in our manufacturing program. PRICES ON REQUEST

			 Go & Nogo Plug		 Go & Nogo Plug	
✓ Available in stock    ○ Manufactured against order			5H RH	6H RH	5H LH	6H LH
Diameter	Pitch	Catalogue Code	5H DR	6H DR	5H DL	6H DL
			M2	0.40	P MS 00002 040	✓
M2.5	0.45	P MS 00025 045	✓	○	○	○
M3	0.5	P MS 00003 050	✓	✓	○	○
M3.5	0.6	P MS 00035 060	✓	○	○	○
M4	0.7	P MS 00004 070	✓	✓	○	○
M4.5	0.75	P MS 00045 075	✓	○	○	○
M5	0.8	P MS 00005 080	✓	✓	○	○
M6	1	P MS 00006 100	✓	✓	○	○
M7	1	P MS 00007 100	✓	✓	○	○
M8	1.25	P MS 00008 125	✓	✓	○	○
M9	1.25	P MS 00009 125	✓	✓	○	○
M10	1.5	P MS 00010 150	✓	✓	○	○
	1.25	P MS 00010 125	✓	✓	○	○
	1	P MS 00010 100	✓	✓	○	○
M12	1.75	P MS 00012 175	✓	✓	○	○
	1.5	P MS 00012 150	✓	✓	○	○
	1.25	P MS 00012 125	✓	✓	○	○
M14	2	P MS 00014 200	✓	✓	○	○
	1.5	P MS 00014 150	✓	✓	○	○
	1.25	P MS 00014 125	✓	✓	○	○
M16	2	P MS 00016 200	✓	✓	○	○
	1.5	P MS 00016 150	✓	✓	○	○
M18	2.5	P MS 00018 250	✓	✓	○	○
	2	P MS 00018 200	✓	✓	○	○
	1.5	P MS 00018 150	✓	✓	○	○
M20	2.5	P MS 00020 250	✓	✓	○	○
	2	P MS 00020 200	✓	○	○	○
	1.5	P MS 00020 150	✓	✓	○	○
M22	2.5	P MS 00022 250	✓	✓	○	○
	2	P MS 00022 200	✓	○	○	○
	1.5	P MS 00022 150	✓	○	○	○
M24	3	P MS 00024 300	✓	✓	○	○
	2	P MS 00024 200	✓	○	○	○
M27	3	P MS 00027 300	✓	○	○	○
M30	3.5	P MS 00030 350	○	○	○	○
M33	3.5	P MS 00033 350	○	○	○	○
M36	4	P MS 00036 400	○	○	○	○
M39	4	P MS 00039 400	○	○	○	○



Specification: **ASME B1.2**

UNC - Unified National Coarse

**Application:** General purpose fastening.  
Imperial system of units (Inch)

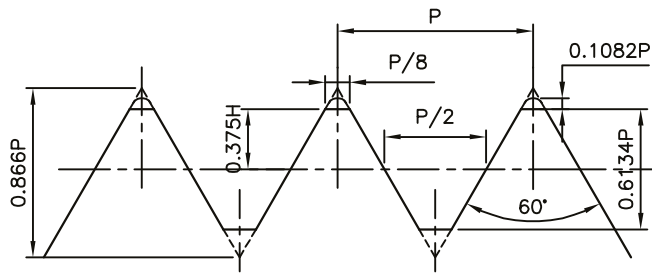

✓ Available in stock   ○ Manufactured against order

1B tolerance is in our manufacturing program. **PRICES ON REQUEST**

Size		Catalogue Code	Go & Nogo Plug		Go & Nogo Plug	
Diameter	TPI		2B RH	3B RH	2B LH	3B LH
			2B DR	3B DR	2B DL	3B DL
No. 1	64	P NC NO001 064	✓	✓	○	○
No. 2	56	P NC NO002 056	✓	✓	○	○
No. 3	48	P NC NO003 048	✓	✓	○	○
No. 4	40	P NC NO004 040	✓	✓	✓	✓
No. 5	40	P NC NO005 040	✓	✓	✓	✓
No. 6	32	P NC NO006 032	✓	✓	✓	✓
No. 8	32	P NC NO008 032	✓	✓	✓	✓
No. 10	24	P NC NO010 024	✓	✓	✓	✓
No. 12	24	P NC NO012 024	✓	✓	✓	✓
1/4	20	P NC 00104 020	✓	✓	✓	✓
5/16	18	P NC 00516 018	✓	✓	✓	✓
3/8	16	P NC 00308 016	✓	✓	✓	✓
7/16	14	P NC 00716 014	✓	✓	✓	✓
1/2	13	P NC 00102 013	✓	✓	✓	✓
9/16	12	P NC 00916 012	✓	✓	✓	✓
5/8	11	P NC 00508 011	✓	✓	✓	✓
3/4	10	P NC 00304 010	✓	✓	✓	✓
7/8	9	P NC 00708 009	✓	✓	✓	✓
1	8	P NC 00100 008	✓	✓	✓	✓
1-1/8	7	P NC 00118 007	✓	✓	○	○
1-1/4	7	P NC 00114 007	✓	✓	○	○
1-3/8	6	P NC 00138 006	✓	✓	○	○
1-1/2	6	P NC 00112 006	✓	✓	○	○

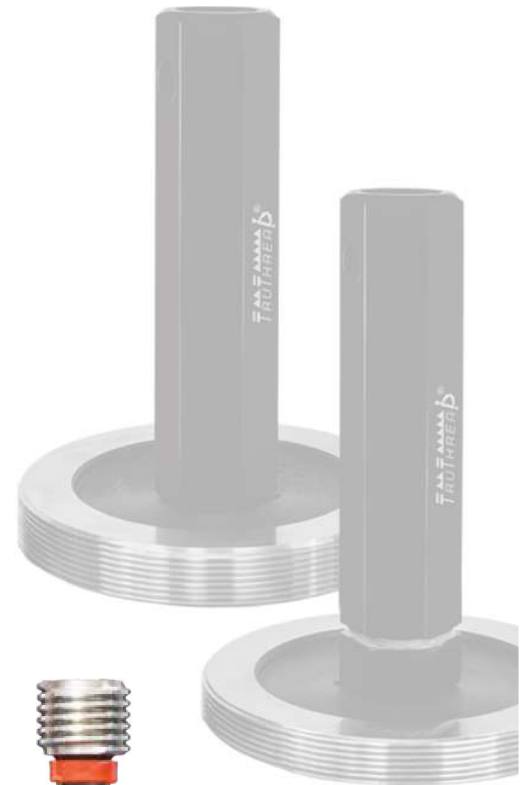

# UNC PLUG



Specification: **ASME B1.2**

UNC - Unified National Coarse

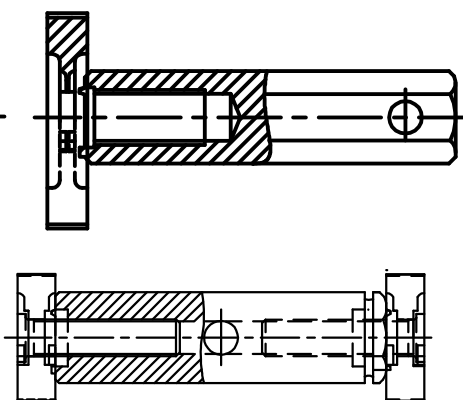
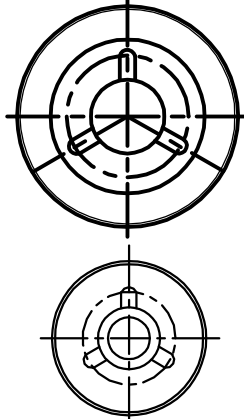

✓ Available in stock   ○ Manufactured against order

1B tolerance is in our manufacturing program. **PRICES ON REQUEST**

Size		Catalogue Code	Right Hand				Left Hand			
			Go Plug 2B RH	Nogo Plug 2B RH	Go Plug 3B RH	Nogo Plug 3B RH	Go Plug 2B LH	Nogo Plug 2B LH	Go Plug 3B LH	Nogo Plug 3B LH
Diameter	TPI		2B GR	2B NR	3B GR	3B NR	2B GL	2B NL	3B GL	3B NL
1-3/4	5	P NC 00134 005	✓	✓	✓	✓	○	○	○	○
2	4.5	P NC 00200 045	✓	✓	✓	✓	○	○	○	○
2-1/4	4.5	P NC 00214 045	○	○	○	○	○	○	○	○
2-1/2	4	P NC 00212 004	○	○	○	○	○	○	○	○
2-3/4	4	P NC 00234 004	○	○	○	○	○	○	○	○
3	4	P NC 00300 004	○	○	○	○	○	○	○	○
3-1/4	4	P NC 00314 004	○	○	○	○	○	○	○	○
3-1/2	4	P NC 00312 004	○	○	○	○	○	○	○	○
3-3/4	4	P NC 00334 004	○	○	○	○	○	○	○	○
4	4	P NC 00400 004	○	○	○	○	○	○	○	○



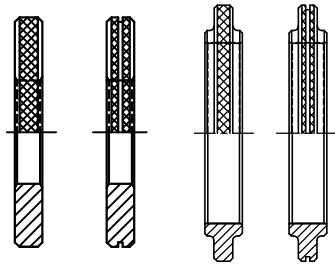

✓ Available in stock   ○ Manufactured against order

1A tolerance is in our manufacturing program. **PRICES ON REQUEST**

			⌚				⌚			
Size		Catalogue Code	Go Ring	Nogo Ring	Go Ring	Nogo Ring	Go Ring	Nogo Ring	Go Ring	Nogo Ring
Diameter	TPI		2A RH	2A RH	3A RH	3A RH	2A LH	2A LH	3A LH	3A LH
			2A GR	2A NR	3A GR	3A NR	2A GL	2A NL	3A GL	3A NL
No. 4	40	R NC NO004 040	✓	✓	✓	✓	✓	✓	✓	✓
No. 5	40	R NC NO005 040	✓	✓	✓	✓	✓	✓	✓	✓
No. 6	32	R NC NO006 032	✓	✓	✓	✓	✓	✓	✓	✓
No. 8	32	R NC NO008 032	✓	✓	✓	✓	✓	✓	✓	✓
No. 10	24	R NC NO010 024	✓	✓	✓	✓	✓	✓	✓	✓
No. 12	24	R NC NO012 024	✓	✓	✓	✓	✓	✓	✓	✓
1/4	20	R NC 00104 020	✓	✓	✓	✓	✓	✓	✓	✓
5/16	18	R NC 00516 018	✓	✓	✓	✓	✓	✓	✓	✓
3/8	16	R NC 00308 016	✓	✓	✓	✓	✓	✓	✓	✓
7/16	14	R NC 00716 014	✓	✓	✓	✓	✓	✓	✓	✓
1/2	13	R NC 00102 013	✓	✓	✓	✓	✓	✓	✓	✓
9/16	12	R NC 00916 012	✓	✓	✓	✓	✓	✓	✓	✓
5/8	11	R NC 00508 011	✓	✓	✓	✓	✓	✓	✓	✓
3/4	10	R NC 00304 010	✓	✓	✓	✓	✓	✓	✓	✓
7/8	9	R NC 00708 009	✓	✓	✓	✓	✓	✓	✓	✓
1	8	R NC 00100 008	✓	✓	✓	✓	✓	✓	✓	✓
1-1/8	7	R NC 00118 007	✓	✓	✓	✓	○	○	○	○
1-1/4	7	R NC 00114 007	✓	✓	✓	✓	○	○	○	○
1-3/8	6	R NC 00138 006	○	○	○	○	○	○	○	○
1-1/2	6	R NC 00112 006	○	○	○	○	○	○	○	○
1-3/4	5	R NC 00134 005	○	○	○	○	○	○	○	○
2	4.5	R NC 00200 045	○	○	○	○	○	○	○	○
2-1/4	4.5	R NC 00214 045	○	○	○	○	○	○	○	○
2-1/2	4	R NC 00212 004	○	○	○	○	○	○	○	○
2-3/4	4	R NC 00234 004	○	○	○	○	○	○	○	○
3	4	R NC 00300 004	○	○	○	○	○	○	○	○
3-1/4	4	R NC 00314 004	○	○	○	○	○	○	○	○
3-1/2	4	R NC 00312 004	○	○	○	○	○	○	○	○
3-3/4	4	R NC 00334 004	○	○	○	○	○	○	○	○
4	4	R NC 00400 004	○	○	○	○	○	○	○	○

# UNF PLUG



Specification: **ASME B1.2**

UNF - Unified National Fine



1B tolerance is in our manufacturing program. PRICES ON REQUEST

✓ Available in stock    ○ Manufactured against order

Size		Catalogue Code				
Diameter	TPI		Go & Nogo Plug	Go & Nogo Plug	Go & Nogo Plug	Go & Nogo Plug
			2B RH	3B RH	2B LH	3B LH
			2B DR	3B DR	2B DL	3B DL
No. 0	80	P NF NO000 080	✓	✓	○	○
No. 1	72	P NF NO001 072	✓	✓	○	○
No. 2	64	P NF NO002 064	✓	✓	○	○
No. 3	56	P NF NO003 056	✓	✓	○	○
No. 4	48	P NF NO004 048	✓	✓	✓	✓
No. 5	44	P NF NO005 044	✓	✓	✓	✓
No. 6	40	P NF NO006 040	✓	✓	✓	✓
No. 8	36	P NF NO008 036	✓	✓	✓	✓
No. 10	32	P NF NO010 032	✓	✓	✓	✓
No. 12	28	P NF NO012 028	✓	✓	✓	✓
¼	28	P NF 00104 028	✓	✓	✓	✓
5/16	24	P NF 00516 024	✓	✓	✓	✓
3/8	24	P NF 00308 024	✓	✓	✓	✓
7/16	20	P NF 00716 020	✓	✓	✓	✓
½	20	P NF 00102 020	✓	✓	✓	✓
9/16	18	P NF 00916 018	✓	✓	✓	✓
5/8	18	P NF 00508 018	✓	✓	✓	✓
¾	16	P NF 00304 016	✓	✓	✓	✓
7/8	14	P NF 00708 014	✓	✓	✓	✓
1	12	P NF 00100 012	✓	✓	✓	✓
1-1/8	12	P NF 00118 012	✓	✓	✓	✓
1-1/4	12	P NF 00114 012	✓	✓	✓	✓
1-3/8	12	P NF 00138 012	✓	✓	✓	✓
1-1/2	12	P NF 00112 012	✓	✓	✓	✓



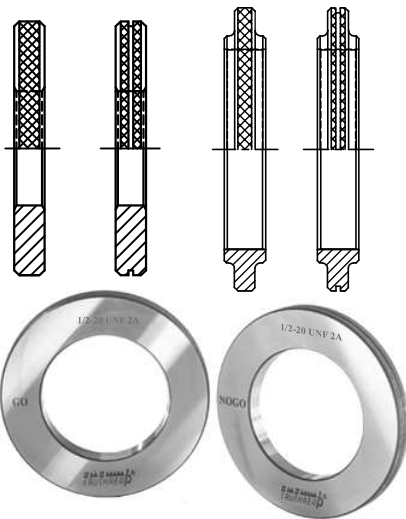

✓ Available in stock   ○ Manufactured against order

1A tolerance is in our manufacturing program. **PRICES ON REQUEST**

Size		Catalogue Code	Right Hand				Left Hand			
			Go Ring 2A RH	Nogo Ring 2A RH	Go Ring 3A RH	Nogo Ring 3A RH	Go Ring 2A LH	Nogo Ring 2A LH	Go Ring 3A LH	Nogo Ring 3A LH
Diameter	TPI		2A GR	2A NR	3A GR	3A NR	2A GL	2A NL	3A GL	3A NL
No. 4	48	R NF NO004 048	✓	✓	✓	✓	○	○	○	○
No. 5	44	R NF NO005 044	✓	✓	✓	✓	✓	✓	○	○
No. 6	40	R NF NO006 040	✓	✓	✓	✓	✓	✓	○	○
No.8	36	R NF NO008 036	✓	✓	✓	✓	✓	✓	○	○
No. 10	32	R NF NO010 032	✓	✓	✓	✓	✓	✓	✓	✓
No. 12	28	R NF NO012 028	✓	✓	✓	✓	✓	✓	✓	✓
1/4	28	R NF 00104 028	✓	✓	✓	✓	✓	✓	✓	✓
5/16	24	R NF 00516 024	✓	✓	✓	✓	✓	✓	✓	✓
3/8	24	R NF 00308 024	✓	✓	✓	✓	✓	✓	✓	✓
7/16	20	R NF 00716 020	✓	✓	✓	✓	✓	✓	✓	✓
1/2	20	R NF 00102 020	✓	✓	✓	✓	✓	✓	✓	✓
9/16	18	R NF 00916 018	✓	✓	✓	✓	✓	✓	✓	✓
5/8	18	R NF 00508 018	✓	✓	✓	✓	✓	✓	✓	✓
3/4	16	R NF 00304 016	✓	✓	✓	✓	✓	✓	✓	✓
7/8	14	R NF 00708 014	✓	✓	✓	✓	✓	✓	✓	✓
1	12	R NF 00100 012	✓	✓	✓	✓	✓	✓	✓	✓
1-1/8	12	R NF 00118 012	✓	✓	✓	✓	○	○	○	○
1-1/4	12	R NF 00114 012	✓	✓	✓	✓	○	○	○	○
1-3/8	12	R NF 00138 012	✓	✓	✓	✓	○	○	○	○
1-1/2	12	R NF 00112 012	✓	✓	✓	✓	○	○	○	○



# UNEF PLUG



Specification: **ASME B1.2**

UNEF - Unified National Extra Fine



1B tolerance is in our manufacturing program. PRICES ON REQUEST

✓ Available in stock    ○ Manufactured against order

Size		Catalogue Code				
Diameter	TPI		Go & Nogo Plug	Go & Nogo Plug	Go & Nogo Plug	Go & Nogo Plug
			2B RH	3B RH	2B LH	3B LH
			2B DR	3B DR	2B DL	3B DL
No. 12	32	P NE NO012 032	✓	✓	✓	✓
1/4	32	P NE 00104 032	✓	✓	✓	✓
5/16	32	P NE 00516 032	✓	✓	✓	✓
3/8	32	P NE 00308 032	✓	✓	✓	✓
7/16	28	P NE 00716 028	✓	✓	✓	✓
1/2	28	P NE 00102 028	✓	✓	✓	✓
9/16	24	P NE 00916 024	✓	✓	✓	✓
5/8	24	P NE 00508 024	✓	✓	✓	✓
11/16	24	P NE 01116 024	✓	✓	✓	✓
3/4	20	P NE 00304 020	✓	✓	✓	✓
13/16	20	P NE 01316 020	✓	✓	✓	✓
7/8	20	P NE 00708 020	✓	✓	✓	✓
15/16	20	P NE 01516 020	✓	✓	✓	✓
1	20	P NE 00100 020	✓	✓	✓	✓
1-1/16	18	P NE 10116 018	✓	✓	○	○
1-1/8	18	P NE 00118 018	✓	✓	○	○
1-3/16	18	P NE 10316 018	✓	✓	○	○
1-1/4	18	P NE 00114 018	✓	✓	○	○
1-5/16	18	P NE 10516 018	✓	✓	○	○
1-3/8	18	P NE 00138 018	✓	✓	○	○
1-7/16	18	P NE 10716 018	✓	✓	○	○
1-1/2	18	P NE 00112 018	✓	○	○	○
1-9/16	18	P NE 10916 018	✓	○	○	○
1-5/8	18	P NE 00158 018	○	○	○	○
1-11/16	18	P NE 11116 018	○	○	○	○





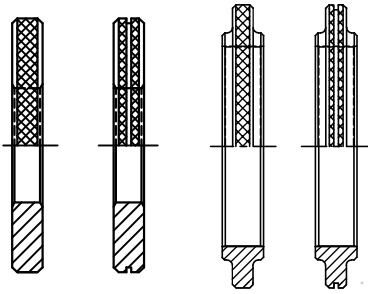

✓ Available in stock   ○ Manufactured against order

1A tolerance is in our manufacturing program. PRICES ON REQUEST

Size		Catalogue Code								
			Go Ring 2A RH	Nogo Ring 2A RH	Go Ring 3A RH	Nogo Ring 3A RH	Go Ring 2A LH	Nogo Ring 2A LH	Go Ring 3A LH	Nogo Ring 3A LH
Diameter	TPI		2A GR	2A NR	3A GR	3A NR	2A GL	2A NL	3A GL	3A NL
No. 12	32	R NE NO012 032	✓	✓	✓	✓	✓	✓	✓	✓
1/4	32	R NE 00104 032	✓	✓	✓	✓	✓	✓	✓	✓
5/16	32	R NE 00516 032	✓	✓	✓	✓	✓	✓	✓	✓
3/8	32	R NE 00308 032	✓	✓	✓	✓	✓	✓	✓	✓
7/16	28	R NE 00716 028	✓	✓	✓	✓	✓	✓	✓	✓
1/2	28	R NE 00102 028	✓	✓	✓	✓	✓	✓	✓	✓
9/16	24	R NE 00916 024	✓	✓	✓	✓	✓	✓	✓	✓
5/8	24	R NE 00508 024	✓	✓	✓	✓	✓	✓	✓	✓
11/16	24	R NE 01116 024	✓	✓	✓	✓	○	○	○	○
3/4	20	R NE 00304 020	✓	✓	✓	✓	✓	✓	✓	✓
13/16	20	R NE 01316 020	✓	✓	✓	✓	○	○	○	○
7/8	20	R NE 00708 020	✓	✓	✓	✓	✓	✓	✓	✓
15/16	20	R NE 01516 020	✓	✓	✓	✓	○	○	○	○
1	20	R NE 00100 020	✓	✓	✓	✓	✓	✓	✓	✓
1-1/16	18	R NE 10116 018	✓	✓	✓	✓	✓	✓	✓	✓
1-1/8	18	R NE 00118 018	✓	✓	✓	✓	✓	✓	✓	✓
1-3/16	18	R NE 10316 018	✓	✓	✓	✓	✓	✓	✓	✓
1-1/4	18	R NE 00114 018	✓	✓	✓	✓	✓	✓	✓	✓
1-5/16	18	R NE 10516 018	✓	✓	✓	✓	✓	✓	✓	✓
1-3/8	18	R NE 00138 018	✓	✓	✓	✓	✓	✓	✓	✓
1-7/16	18	R NE 10716 018	✓	✓	✓	✓	○	○	○	○
1-1/2	18	R NE 00112 018	✓	✓	✓	✓	✓	✓	✓	✓
1-9/16	18	R NE 10916 018	✓	✓	✓	✓	○	○	○	○
1-5/8	18	R NE 00158 018	✓	✓	✓	✓	○	○	○	○
1-11/16	18	R NE 11116 018	○	○	○	○	○	○	○	○



Specification: **ASME B1.2**

UN - Unified National Constant TPI



			Go & Nogo Plug	Go & Nogo Plug	Go & Nogo Plug	Go & Nogo Plug
			2B RH	3B RH	2B LH	3B LH
			2B DR	3B DR	2B DL	3B DL
Size		Catalogue Code				
Diameter	TPI					
5/8	20	P UN 00508 020	✓	✓	✓	✓
3/4	12	P UN 00304 012	✓	✓	✓	✓
7/8	12	P UN 00708 012	✓	✓	✓	✓
	16	P UN 00708 016	✓	✓	✓	✓
1	16	P UN 00100 016	✓	✓	✓	✓
	28	P UN 00100 028	✓	✓	✓	✓
	32	P UN 00100 032	✓	✓	✓	✓
1-1/16	12	P UN 10116 012	✓	✓	✓	✓
1-1/8	8	P UN 00118 008	✓	✓	✓	✓
	16	P UN 00118 016	○	○	○	○
	20	P UN 00118 020	○	○	○	○
1-1/4	8	P UN 00114 008	✓	✓	✓	✓
	16	P UN 00114 016	○	○	○	○
	20	P UN 00114 020	○	○	○	○
1-3/8	8	P UN 00138 008	✓	✓	✓	✓
	16	P UN 00138 016	○	○	○	○
	20	P UN 00138 020	○	○	○	○
1-1/2	8	P UN 00112 008	✓	✓	✓	✓
	16	P UN 00112 016	✓	✓	✓	✓
	20	P UN 00112 020	✓	✓	✓	✓
1-5/8	8	P UN 00158 008	✓	✓	✓	✓
	12	P UN 00158 012	✓	✓	✓	✓
1-3/4	8	P UN 00134 008	✓	✓	✓	✓
	12	P UN 00134 012	✓	✓	✓	✓
	20	P UN 00134 020	○	○	○	○
1-7/8	8	P UN 00178 008	✓	✓	✓	✓
	12	P UN 00178 012	✓	✓	✓	✓
2	8	P UN 00200 008	✓	✓	✓	✓
	12	P UN 00200 012	✓	✓	✓	✓
2-1/8	6	P UN 00218 006	○	○	○	○
	8	P UN 00218 008	✓	✓	✓	✓
	12	P UN 00218 012	✓	✓	✓	✓
2-1/4	8	P UN 00214 008	✓	✓	✓	✓
	12	P UN 00214 012	✓	✓	✓	✓
2-3/8	8	P UN 00238 008	✓	✓	✓	✓
	12	P UN 00238 012	✓	✓	✓	✓
2-1/2	8	P UN 00212 008	✓	✓	✓	✓
	12	P UN 00212 012	✓	✓	✓	✓

✓ Available in stock ○ Manufactured against order

The Sizes & tolerances not covered in catalogue are in our manufacturing program. PRICES ON REQUEST



Specification: **ASME B1.2**

UN - Unified National Constant TPI

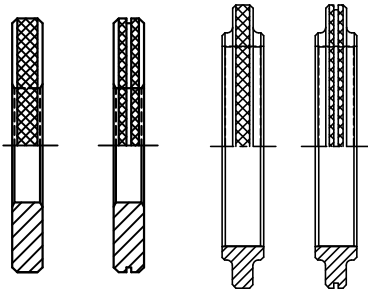

✓ Available in stock    ○ Manufactured against order

The Sizes & tolerances not covered in catalogue are in our manufacturing program. **PRICES ON REQUEST**

Size			Catalogue Code	Go Ring    Nogo Ring    Go Ring    Nogo Ring				Go Ring    Nogo Ring    Go Ring    Nogo Ring			
Diameter	TPI			2A RH	2A RH	3A RH	3A RH	2A LH	2A LH	3A LH	3A LH
				2A GR	2A NR	3A GR	3A NR	2A GL	2A NL	3A GL	3A NL
5/8	20		R UN 00508 020	✓	✓	○	○	○	○	○	○
3/4	12		R UN 00304 012	✓	✓	○	○	○	○	○	○
7/8	12		R UN 00708 012	✓	✓	○	○	○	○	○	○
	16		R UN 00708 016	✓	✓	○	○	○	○	○	○
1	16		R UN 00100 016	✓	✓	✓	✓	○	○	○	○
	28		R UN 00100 028	✓	✓	✓	✓	○	○	○	○
	32		R UN 00100 032	✓	✓	○	○	○	○	○	○
	1-1/16	12	R UN 10116 012	✓	✓	○	○	○	○	○	○
1-1/8	8		R UN 00118 008	✓	✓	✓	✓	○	○	○	○
	16		R UN 00118 016	✓	✓	✓	✓	○	○	○	○
	20		R UN 00118 020	✓	✓	○	○	○	○	○	○
1-1/4	8		R UN 00114 008	✓	✓	✓	✓	○	○	○	○
	16		R UN 00114 016	✓	✓	✓	✓	○	○	○	○
	20		R UN 00114 020	✓	✓	✓	✓	○	○	○	○
1-3/8	8		R UN 00138 008	✓	✓	✓	✓	○	○	○	○
	16		R UN 00138 016	✓	✓	○	○	○	○	○	○
	20		R UN 00138 020	✓	✓	○	○	○	○	○	○
1-1/2	8		R UN 00112 008	✓	✓	✓	✓	○	○	○	○
	16		R UN 00112 016	✓	✓	○	○	○	○	○	○
	20		R UN 00112 020	✓	✓	○	○	○	○	○	○
1-5/8	8		R UN 00158 008	✓	✓	○	○	○	○	○	○
	12		R UN 00158 012	✓	✓	○	○	○	○	○	○
1-3/4	8		R UN 00134 008	✓	✓	✓	✓	○	○	○	○
	12		R UN 00134 012	✓	✓	✓	✓	○	○	○	○
	20		R UN 00134 020	✓	✓	○	○	○	○	○	○
1-7/8	8		R UN 00178 008	✓	✓	○	○	○	○	○	○
	12		R UN 00178 012	✓	✓	○	○	○	○	○	○
2	8		R UN 00200 008	✓	✓	✓	✓	○	○	○	○
	12		R UN 00200 012	✓	✓	○	○	○	○	○	○
2-1/8	6		R UN 00218 006	✓	✓	○	○	○	○	○	○
	8		R UN 00218 008	✓	✓	✓	✓	○	○	○	○
	12		R UN 00218 012	✓	✓	○	○	○	○	○	○
2-1/4	8		R UN 00214 008	✓	✓	✓	✓	○	○	○	○
	12		R UN 00214 012	✓	✓	✓	✓	○	○	○	○
2-3/8	8		R UN 00238 008	✓	✓	○	○	○	○	○	○
	12		R UN 00238 012	✓	✓	○	○	○	○	○	○
2-1/2	8		R UN 00212 008	✓	✓	✓	✓	○	○	○	○
	12		R UN 00212 012	✓	✓	✓	✓	○	○	○	○

Specification: **ASME B1.2**

UN - Unified National Constant TPI



✓ Available in stock   ○ Manufactured against order

The Sizes & tolerances not covered in catalogue are in our manufacturing program. **PRICES ON REQUEST**

Size		Catalogue Code								
			Go Plug 2B RH	Nogo Plug 2B RH	Go Plug 3B RH	Nogo Plug 3B RH	Go Plug 2B LH	Nogo Plug 2B LH	Go Plug 3B LH	Nogo Plug 3B LH
Diameter	TPI		2B GR	2B NR	3B GR	3B NR	2B GL	2B NL	3B GL	3B NL
2-5/8	8	P UN 00258 008	○	○	○	○	○	○	○	○
	12	P UN 00258 012	○	○	○	○	○	○	○	○
	16	P UN 00258 016	○	○	○	○	○	○	○	○
2-3/4	8	P UN 00234 008	✓	✓	○	○	○	○	○	○
	12	P UN 00234 012	✓	✓	○	○	○	○	○	○
	16	P UN 00234 016	○	○	○	○	○	○	○	○
2-7/8	8	P UN 00278 008	○	○	○	○	○	○	○	○
	12	P UN 00278 012	○	○	○	○	○	○	○	○
	16	P UN 00278 016	○	○	○	○	○	○	○	○
3	8	P UN 00300 008	✓	✓	○	○	○	○	○	○
	12	P UN 00300 012	✓	✓	○	○	○	○	○	○
	16	P UN 00300 016	○	○	○	○	○	○	○	○
3-1/8	8	P UN 00318 008	✓	✓	○	○	○	○	○	○
	12	P UN 00318 012	○	○	○	○	○	○	○	○
	16	P UN 00318 016	○	○	○	○	○	○	○	○
3-1/4	8	P UN 00314 008	✓	✓	○	○	○	○	○	○
	12	P UN 00314 012	○	○	○	○	○	○	○	○
	16	P UN 00314 016	○	○	○	○	○	○	○	○
3-1/2	8	P UN 00312 008	✓	✓	○	○	○	○	○	○
	12	P UN 00312 012	✓	✓	○	○	○	○	○	○
	16	P UN 00312 016	○	○	○	○	○	○	○	○
3-3/4	8	P UN 00334 008	✓	✓	○	○	○	○	○	○
	12	P UN 00334 012	✓	✓	○	○	○	○	○	○
	16	P UN 00334 016	○	○	○	○	○	○	○	○
4	8	P UN 00400 008	○	○	○	○	○	○	○	○
	12	P UN 00400 012	○	○	○	○	○	○	○	○
	16	P UN 00400 016	○	○	○	○	○	○	○	○

**Our manufacturing program includes -**

- Thread Plugs with Tolerance class **1B**
- UNS (UNIFIED NATIONAL SPECIAL) Thread series with Dia.- TPI combinations not covered in the catalogue.
- Thread sizes with nominal Diameter above 4 Inch & up to 14 Inch

**PRICES ON REQUEST**

Specification: **ASME B1.2**

UN - Unified National Constant TPI

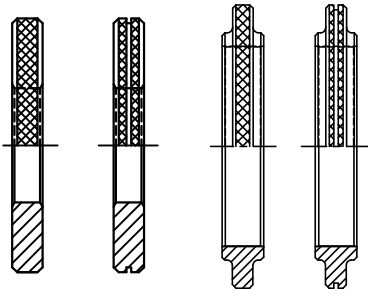

The Sizes & tolerances not covered in catalogue are in our manufacturing program. **PRICES ON REQUEST**

			↻				↻			
			Go Ring	Nogo Ring	Go Ring	Nogo Ring	Go Ring	Nogo Ring	Go Ring	Nogo Ring
			2A RH	2A RH	3A RH	3A RH	2A LH	2A LH	3A LH	3A LH
Size		Catalogue Code	2A GR	2A NR	3A GR	3A NR	2A GL	2A NL	3A GL	3A NL
Diameter	TPI		2A GR	2A NR	3A GR	3A NR	2A GL	2A NL	3A GL	3A NL
2-5/8	8	R UN 00258 008	<input type="checkbox"/>	<input type="checkbox"/>	<input type="checkbox"/>	<input type="checkbox"/>	<input type="checkbox"/>	<input type="checkbox"/>	<input type="checkbox"/>	<input type="checkbox"/>
	12	R UN 00258 012	<input type="checkbox"/>	<input type="checkbox"/>	<input type="checkbox"/>	<input type="checkbox"/>	<input type="checkbox"/>	<input type="checkbox"/>	<input type="checkbox"/>	<input type="checkbox"/>
	16	R UN 00258 016	<input type="checkbox"/>	<input type="checkbox"/>	<input type="checkbox"/>	<input type="checkbox"/>	<input type="checkbox"/>	<input type="checkbox"/>	<input type="checkbox"/>	<input type="checkbox"/>
2-3/4	8	R UN 00234 008	<input type="checkbox"/>	<input type="checkbox"/>	<input type="checkbox"/>	<input type="checkbox"/>	<input type="checkbox"/>	<input type="checkbox"/>	<input type="checkbox"/>	<input type="checkbox"/>
	12	R UN 00234 012	<input type="checkbox"/>	<input type="checkbox"/>	<input type="checkbox"/>	<input type="checkbox"/>	<input type="checkbox"/>	<input type="checkbox"/>	<input type="checkbox"/>	<input type="checkbox"/>
	16	R UN 00234 016	<input type="checkbox"/>	<input type="checkbox"/>	<input type="checkbox"/>	<input type="checkbox"/>	<input type="checkbox"/>	<input type="checkbox"/>	<input type="checkbox"/>	<input type="checkbox"/>
2-7/8	8	R UN 00278 008	<input type="checkbox"/>	<input type="checkbox"/>	<input type="checkbox"/>	<input type="checkbox"/>	<input type="checkbox"/>	<input type="checkbox"/>	<input type="checkbox"/>	<input type="checkbox"/>
	12	R UN 00278 012	<input type="checkbox"/>	<input type="checkbox"/>	<input type="checkbox"/>	<input type="checkbox"/>	<input type="checkbox"/>	<input type="checkbox"/>	<input type="checkbox"/>	<input type="checkbox"/>
	16	R UN 00278 016	<input type="checkbox"/>	<input type="checkbox"/>	<input type="checkbox"/>	<input type="checkbox"/>	<input type="checkbox"/>	<input type="checkbox"/>	<input type="checkbox"/>	<input type="checkbox"/>
3	8	R UN 00300 008	<input type="checkbox"/>	<input type="checkbox"/>	<input type="checkbox"/>	<input type="checkbox"/>	<input type="checkbox"/>	<input type="checkbox"/>	<input type="checkbox"/>	<input type="checkbox"/>
	12	R UN 00300 012	<input type="checkbox"/>	<input type="checkbox"/>	<input type="checkbox"/>	<input type="checkbox"/>	<input type="checkbox"/>	<input type="checkbox"/>	<input type="checkbox"/>	<input type="checkbox"/>
	16	R UN 00300 016	<input type="checkbox"/>	<input type="checkbox"/>	<input type="checkbox"/>	<input type="checkbox"/>	<input type="checkbox"/>	<input type="checkbox"/>	<input type="checkbox"/>	<input type="checkbox"/>
3-1/8	8	R UN 00318 008	<input type="checkbox"/>	<input type="checkbox"/>	<input type="checkbox"/>	<input type="checkbox"/>	<input type="checkbox"/>	<input type="checkbox"/>	<input type="checkbox"/>	<input type="checkbox"/>
	12	R UN 00318 012	<input type="checkbox"/>	<input type="checkbox"/>	<input type="checkbox"/>	<input type="checkbox"/>	<input type="checkbox"/>	<input type="checkbox"/>	<input type="checkbox"/>	<input type="checkbox"/>
	16	R UN 00318 016	<input type="checkbox"/>	<input type="checkbox"/>	<input type="checkbox"/>	<input type="checkbox"/>	<input type="checkbox"/>	<input type="checkbox"/>	<input type="checkbox"/>	<input type="checkbox"/>
3-1/4	8	R UN 00314 008	<input type="checkbox"/>	<input type="checkbox"/>	<input type="checkbox"/>	<input type="checkbox"/>	<input type="checkbox"/>	<input type="checkbox"/>	<input type="checkbox"/>	<input type="checkbox"/>
	12	R UN 00314 012	<input type="checkbox"/>	<input type="checkbox"/>	<input type="checkbox"/>	<input type="checkbox"/>	<input type="checkbox"/>	<input type="checkbox"/>	<input type="checkbox"/>	<input type="checkbox"/>
	16	R UN 00314 016	<input type="checkbox"/>	<input type="checkbox"/>	<input type="checkbox"/>	<input type="checkbox"/>	<input type="checkbox"/>	<input type="checkbox"/>	<input type="checkbox"/>	<input type="checkbox"/>
3-1/2	8	R UN 00312 008	<input type="checkbox"/>	<input type="checkbox"/>	<input type="checkbox"/>	<input type="checkbox"/>	<input type="checkbox"/>	<input type="checkbox"/>	<input type="checkbox"/>	<input type="checkbox"/>
	12	R UN 00312 012	<input type="checkbox"/>	<input type="checkbox"/>	<input type="checkbox"/>	<input type="checkbox"/>	<input type="checkbox"/>	<input type="checkbox"/>	<input type="checkbox"/>	<input type="checkbox"/>
	16	R UN 00312 016	<input type="checkbox"/>	<input type="checkbox"/>	<input type="checkbox"/>	<input type="checkbox"/>	<input type="checkbox"/>	<input type="checkbox"/>	<input type="checkbox"/>	<input type="checkbox"/>
3-3/4	8	R UN 00334 008	<input type="checkbox"/>	<input type="checkbox"/>	<input type="checkbox"/>	<input type="checkbox"/>	<input type="checkbox"/>	<input type="checkbox"/>	<input type="checkbox"/>	<input type="checkbox"/>
	12	R UN 00334 012	<input type="checkbox"/>	<input type="checkbox"/>	<input type="checkbox"/>	<input type="checkbox"/>	<input type="checkbox"/>	<input type="checkbox"/>	<input type="checkbox"/>	<input type="checkbox"/>
	16	R UN 00334 016	<input type="checkbox"/>	<input type="checkbox"/>	<input type="checkbox"/>	<input type="checkbox"/>	<input type="checkbox"/>	<input type="checkbox"/>	<input type="checkbox"/>	<input type="checkbox"/>
4	8	R UN 00400 008	<input type="checkbox"/>	<input type="checkbox"/>	<input type="checkbox"/>	<input type="checkbox"/>	<input type="checkbox"/>	<input type="checkbox"/>	<input type="checkbox"/>	<input type="checkbox"/>
	12	R UN 00400 012	<input type="checkbox"/>	<input type="checkbox"/>	<input type="checkbox"/>	<input type="checkbox"/>	<input type="checkbox"/>	<input type="checkbox"/>	<input type="checkbox"/>	<input type="checkbox"/>
	16	R UN 00400 016	<input type="checkbox"/>	<input type="checkbox"/>	<input type="checkbox"/>	<input type="checkbox"/>	<input type="checkbox"/>	<input type="checkbox"/>	<input type="checkbox"/>	<input type="checkbox"/>

**Our manufacturing program includes -**

- Thread Rings with Tolerance class **1A**
- UNS (UNIFIED NATIONAL SPECIAL) Thread series with Dia.- TPI combinations not covered in the catalogue.
- Thread sizes with nominal Diameter above 4 Inch & up to 14 Inch

**PRICES ON REQUEST**

Specification: **ASME B1.15**  
**ISO 3161/BS 4084**

**Application :** Used in Aeronautical industry for Imperial system of units.

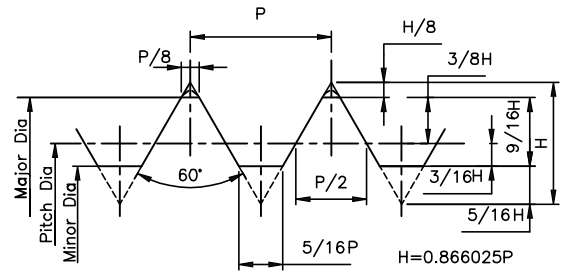

The Tolerances not covered in catalogue are in our manufacturing program. **PRICES ON REQUEST**

✓ Available in stock    ○ Manufactured against order

Size		Catalogue Code	Go & Nogo Plug	
Diameter	TPI		3B RH	3B DR
No. 4	40	P JC NO004 040	✓	
No. 5	40	P JC NO005 040	✓	
No. 6	32	P JC NO006 032	✓	
No. 8	32	P JC NO008 032	✓	
No. 10	24	P JC NO010 024	✓	
No. 12	24	P JC NO012 024	✓	
1/4	20	P JC 00104 020	✓	
5/16	18	P JC 00516 018	✓	
3/8	16	P JC 00308 016	✓	
7/16	14	P JC 00716 014	✓	
1/2	13	P JC 00102 013	✓	
9/16	12	P JC 00916 012	✓	
5/8	11	P JC 00508 011	✓	
3/4	10	P JC 00304 010	✓	
7/8	9	P JC 00708 009	✓	
1	8	P JC 00100 008	✓	

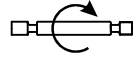

Go & Nogo Plug

3B RH

3B DR



Go Ring

Nogo Ring

3A RH

3A RH

3A GR

3A NR

Size		Catalogue Code		
Diameter	TPI		3A GR	3A NR
No. 4	40	R JC NO004 040	✓	✓
No. 5	40	R JC NO005 040	✓	✓
No. 6	32	R JC NO006 032	✓	✓
No. 8	32	R JC NO008 032	✓	✓
No. 10	24	R JC NO010 024	✓	✓
No. 12	24	R JC NO012 024	✓	✓
1/4	20	R JC 00104 020	✓	✓
5/16	18	R JC 00516 018	✓	✓
3/8	16	R JC 00308 016	✓	✓
7/16	14	R JC 00716 014	✓	✓
1/2	13	R JC 00102 013	✓	✓
9/16	12	R JC 00916 012	✓	✓
5/8	11	R JC 00508 011	✓	✓
3/4	10	R JC 00304 010	✓	✓
7/8	9	R JC 00708 009	✓	✓
1	8	R JC 00100 008	✓	✓



Specification: **ASME B1.15**  
**ISO 3161/BS 4084**

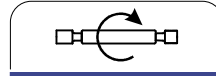

Go & Nogo Plug

3B RH

✓ Available in stock   ○ Manufactured against order

Size		Catalogue Code	3B DR
Diameter	TPI		
No. 4	48	P JF NO004 048	✓
No. 5	44	P JF NO005 044	✓
No. 6	40	P JF NO006 040	✓
No. 8	36	P JF NO008 036	✓
No. 10	32	P JF NO010 032	✓
No. 12	28	P JF NO012 028	✓
1/4	28	P JF 00104 028	✓
5/16	24	P JF 00516 024	✓
3/8	24	P JF 00308 024	✓
7/16	20	P JF 00716 020	✓
1/2	20	P JF 00102 020	✓
9/16	18	P JF 00916 018	✓
5/8	18	P JF 00508 018	✓
3/4	16	P JF 00304 016	✓
7/8	14	P JF 00708 014	✓
1	12	P JF 00100 012	✓

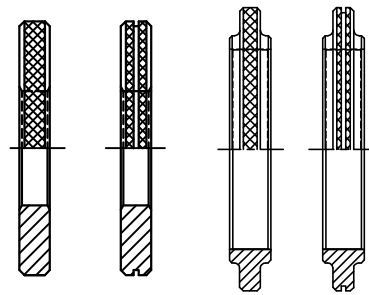

Go Ring

Nogo Ring

3A RH

3A RH

3A GR

3A NR

Size		Catalogue Code	3A GR	3A NR
Diameter	TPI			
No. 4	48	R JF NO004 048	✓	✓
No. 5	44	R JF NO005 044	✓	✓
No. 6	40	R JF NO006 040	✓	✓
No. 8	36	R JF NO008 036	✓	✓
No. 10	32	R JF NO010 032	✓	✓
No. 12	28	R JF NO012 028	✓	✓
1/4	28	R JF 00104 028	✓	✓
5/16	24	R JF 00516 024	✓	✓
3/8	24	R JF 00308 024	✓	✓
7/16	20	R JF 00716 020	✓	✓
1/2	20	R JF 00102 020	✓	✓
9/16	18	R JF 00916 018	✓	✓
5/8	18	R JF 00508 018	✓	✓
3/4	16	R JF 00304 016	✓	✓
7/8	14	R JF 00708 014	✓	✓
1	12	R JF 00100 012	✓	✓



The Tolerances not covered in catalogue are in our manufacturing program. **PRICES ON REQUEST**

# UNJEF PLUG / RING



Specification: ASME B1.15  
ISO 3161/BS 4084



✓ Available in stock ○ Manufactured against order

Size		Catalogue Code	Go & Nogo Plug	
Diameter	TPI		3B RH	3B DR
No. 12	32	P JE NO012 032	✓	✓
1/4	32	P JE 00104 032	✓	✓
5/16	32	P JE 00516 032	✓	✓
3/8	32	P JE 00308 032	✓	✓
7/16	28	P JE 00716 028	✓	✓
1/2	28	P JE 00102 028	✓	✓
9/16	24	P JE 00916 024	✓	✓
5/8	24	P JE 00508 024	✓	✓
11/16	24	P JE 01116 024	○	○
3/4	20	P JE 00304 020	○	○
13/16	20	P JE 01316 020	○	○
7/8	20	P JE 00708 020	○	○
15/16	20	P JE 01516 020	○	○
1	20	P JE 00100 020	○	○



Go & Nogo Plug

3B RH

3B DR



Go Ring

Nogo Ring

3A RH

3A RH

3A GR

3A NR

Size		Catalogue Code	Go & Nogo Ring	
Diameter	TPI		3A RH	3A RH
No. 12	32	R JE NO012 032	✓	✓
1/4	32	R JE 00104 032	✓	✓
5/16	32	R JE 00516 032	✓	✓
3/8	32	R JE 00308 032	✓	✓
7/16	28	R JE 00716 028	✓	✓
1/2	28	R JE 00102 028	✓	✓
9/16	24	R JE 00916 024	○	○
5/8	24	R JE 00508 024	○	○
11/16	24	R JE 01116 024	○	○
3/4	20	R JE 00304 020	○	○
13/16	20	R JE 01316 020	○	○
7/8	20	R JE 00708 020	○	○
15/16	20	R JE 01516 020	○	○
1	20	R JE 00100 020	○	○

The Tolerances not covered in catalogue are in our manufacturing program. PRICES ON REQUEST

# UNJ PLUG / RING

✓ Available in stock ○ Manufactured against order

Size		Catalogue Code	Go & Nogo Plug	
Diameter	TPI		3B RH	3B DR
9/16	20	P JN 00916 020	✓	
5/8	20	P JN 00508 020	✓	
3/4	12	P JN 00304 012	✓	
13/16	12	P JN 01316 012	○	
	16	P JN 01316 016	○	
7/8	12	P JN 00708 012	✓	
	16	P JN 00708 016	✓	
15/16	12	P JN 01516 012	○	
	16	P JN 01516 016	○	
1	16	P JN 00100 016	○	



Go & Nogo Plug

3B RH

3B DR



Go Ring

Nogo Ring

3A RH

3A RH

3A GR

3A NR

Size		Catalogue Code	Go & Nogo Ring	
Diameter	TPI		3A RH	3A RH
9/16	20	R JN 00916 020	✓	✓
5/8	20	R JN 00508 020	✓	✓
3/4	12	R JN 00304 012	✓	✓
13/16	12	R JN 01316 012	○	○
	16	R JN 01316 016	○	○
7/8	12	R JN 00708 012	✓	✓
	16	R JN 00708 016	✓	✓
15/16	12	R JN 01516 012	○	○
	16	R JN 01516 016	○	○
1	16	R JN 00100 016	○	○



**UNC & UNF**

**Application:** To check tapped holes to receive wire thread inserts.

These gauges are used for checking oversize tapping which is done for fitting wire thread inserts. Wire thread inserts are having external threads which are oversize than the standard size and internal threads which are of standard dimensions. When tapped internal threads become oversize and standard screw cannot be fitted then wire threads inserts are used. Oversize tapping is done using wire thread taps and wire thread inserts are fitted in this.

☛ These are also known as Heli-coil thread inserts. 'Heli-coil' is a registered Trade mark of Emhart Technologies, USA.

**TOLERANCE CLASS :** 2B & 3B classes are recommended for Unified threads.



				Go & Nogo Plug	Go & Nogo Plug	Go & Nogo Plug	Go & Nogo Plug
				2B RH	3B RH	2B LH	3B LH
				2B DR	3B DR	2B DL	3B DL
✓ Available in stock ○ Manufactured against order							
Size		Catalogue Code					
Diameter	TPI						
No. 4	40	UNC	P CS NO004 040	✓	✓	✓	○
No. 5	40	UNC	P CS NO005 040	✓	✓	✓	○
No. 6	32	UNC	P CS NO006 032	✓	✓	✓	○
No. 8	32	UNC	P CS NO008 032	✓	✓	✓	○
No. 10	24	UNC	P CS NO010 024	✓	✓	✓	○
No. 12	24	UNC	P CS NO012 024	✓	✓	✓	○
¼	20	UNC	P CS 00104 020	✓	✓	✓	○
5/16	18	UNC	P CS 00516 018	✓	✓	✓	○
3/8	16	UNC	P CS 00308 016	✓	✓	✓	○
7/16	14	UNC	P CS 00716 014	✓	✓	✓	○
½	13	UNC	P CS 00102 013	✓	✓	✓	○
9/16	12	UNC	P CS 00916 012	✓	✓	✓	○
5/8	11	UNC	P CS 00508 011	✓	✓	✓	○
¾	10	UNC	P CS 00304 010	✓	✓	✓	○
7/8	9	UNC	P CS 00708 009	✓	✓	✓	○
1	8	UNC	P CS 00100 008	✓	✓	✓	○
No.4	48	UNF	P FS NO004 048	✓	✓	✓	○
No.5	44	UNF	P FS NO005 044	✓	✓	✓	○
No.6	40	UNF	P FS NO006 040	✓	✓	✓	○
No.8	36	UNF	P FS NO008 036	✓	✓	✓	○
No.10	32	UNF	P FS NO010 032	✓	✓	✓	○
No.12	28	UNF	P FS NO012 028	✓	✓	✓	○
¼	28	UNF	P FS 00104 028	✓	✓	✓	○
5/16	24	UNF	P FS 00516 024	✓	✓	✓	○
3/8	24	UNF	P FS 00308 024	✓	✓	✓	○
7/16	20	UNF	P FS 00716 020	✓	✓	✓	○
½	20	UNF	P FS 00102 020	✓	✓	✓	○
9/16	18	UNF	P FS 00916 018	✓	✓	✓	○
5/8	18	UNF	P FS 00508 018	✓	✓	✓	○
¾	16	UNF	P FS 00304 016	✓	✓	✓	○
7/8	14	UNF	P FS 00708 014	✓	✓	✓	○
1	12	UNF	P FS 00100 012	✓	✓	✓	○

The Sizes not covered in catalogue are in our manufacturing program. PRICES ON REQUEST



# G - PIPE THREAD PLUG



Specification: ISO 228

**Application:** General purpose pipe threads, where pressure tight joints are not required on threads.

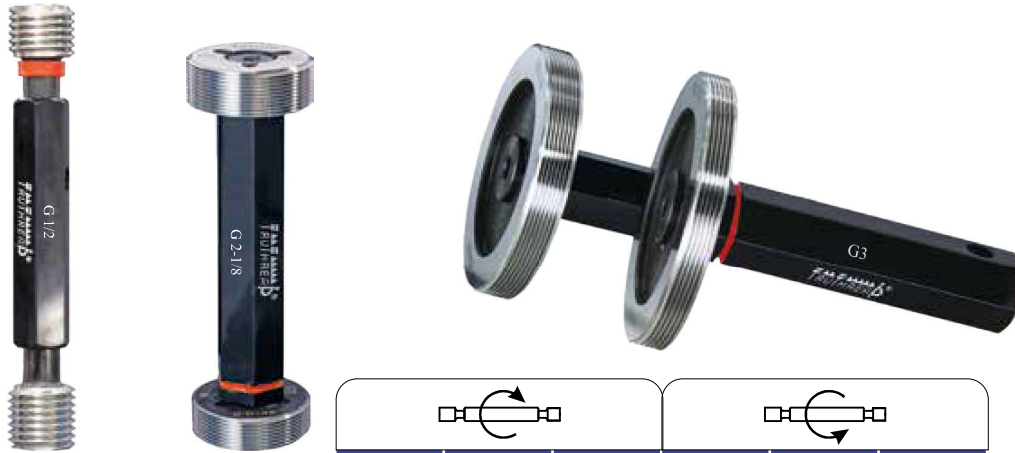
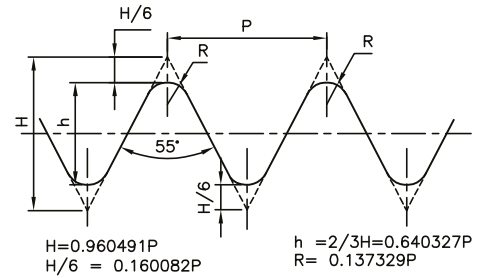

✓ Available in stock   ○ Manufactured against order

The Sizes not covered in catalogue are in our manufacturing program. PRICES ON REQUEST

Size		Catalogue Code						
Diameter	TPI		Go & Nogo Plug RH	Go Plug RH	Nogo Plug RH	Go & Nogo Plug LH	Go Plug LH	Nogo Plug LH
			00 DR	00 GR	00 NR	00 DL	00 GL	00 NL
G 1/8	28	P GG 00108 028	✓	NA	NA	✓	NA	NA
G 1/4	19	P GG 00104 019	✓	NA	NA	✓	NA	NA
G 3/8	19	P GG 00308 019	✓	NA	NA	✓	NA	NA
G 1/2	14	P GG 00102 014	✓	NA	NA	✓	NA	NA
G 5/8	14	P GG 00508 014	✓	NA	NA	✓	NA	NA
G 3/4	14	P GG 00304 014	✓	NA	NA	✓	NA	NA
G 7/8	14	P GG 00708 014	✓	NA	NA	✓	NA	NA
G 1	11	P GG 00100 011	✓	NA	NA	✓	NA	NA
G 1-1/8	11	P GG 00118 011	✓	NA	NA	✓	NA	NA
G1-1/4	11	P GG 00114 011	✓	NA	NA	✓	NA	NA
G 1-3/8	11	P GG 00138 011	✓	NA	NA	✓	NA	NA
G 1-1/2	11	P GG 00112 011	✓	NA	NA	✓	NA	NA
G 1-3/4	11	P GG 00134 011	✓	NA	NA	✓	NA	NA
G 2	11	P GG 00200 011	✓	NA	NA	✓	NA	NA
G 2-1/4	11	P GG 00214 011	NA	✓	✓	NA	○	○
G 2-1/2	11	P GG 00212 011	NA	✓	✓	NA	○	○
G 2-3/4	11	P GG 00234 011	NA	✓	✓	NA	○	○
G 3	11	P GG 00300 011	NA	✓	✓	NA	○	○
G 3-1/2	11	P GG 00312 011	NA	✓	✓	NA	○	○
G 4	11	P GG 00400 011	NA	✓	✓	NA	○	○
G 5	11	P GG 00500 011	NA	○	○	NA	○	○
G 6	11	P GG 00600 011	NA	○	○	NA	○	○

NA - Not Applicable

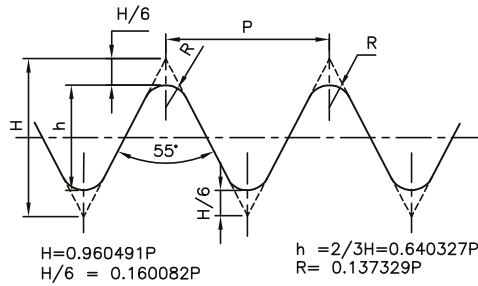

The Sizes not covered in catalogue are in our manufacturing program. PRICES ON REQUEST

✓ Available in stock    ○ Manufactured against order

Size		Catalogue Code	Right Hand (RH)				Left Hand (LH)			
Diameter	TPI		Go Ring Class-A RH	Nogo Ring Class-A RH	Go Ring Class-B RH	Nogo Ring Class-B RH	Go Ring Class-A LH	Nogo Ring Class-A LH	Go Ring Class-B LH	Nogo Ring Class-B LH
			A0 GR	A0 NR	B0 GR	B0 NR	A0 GL	A0 NL	B0 GL	B0 NL
G 1/8	28	R GG 00108 028	✓	✓	✓	✓	✓	✓	○	○
G 1/4	19	R GG 00104 019	✓	✓	✓	✓	✓	✓	○	○
G 3/8	19	R GG 00308 019	✓	✓	✓	✓	✓	✓	○	○
G 1/2	14	R GG 00102 014	✓	✓	✓	✓	✓	✓	○	○
G 5/8	14	R GG 00508 014	✓	✓	✓	✓	✓	✓	○	○
G 3/4	14	R GG 00304 014	✓	✓	✓	✓	✓	✓	○	○
G 7/8	14	R GG 00708 014	✓	✓	✓	✓	○	○	○	○
G 1	11	R GG 00100 011	✓	✓	✓	✓	✓	✓	○	○
G 1-1/8	11	R GG 00118 011	✓	✓	✓	✓	○	○	○	○
G1-1/4	11	R GG 00114 011	✓	✓	✓	✓	✓	✓	○	○
G 1-3/8	11	R GG 00138 011	✓	✓	✓	✓	○	○	○	○
G 1-1/2	11	R GG 00112 011	✓	✓	✓	✓	✓	✓	○	○
G 1-3/4	11	R GG 00134 011	✓	✓	✓	✓	✓	✓	○	○
G 2	11	R GG 00200 011	✓	✓	✓	✓	✓	✓	○	○
G 2-1/4	11	R GG 00214 011	✓	✓	✓	✓	✓	✓	○	○
G 2-1/2	11	R GG 00212 011	✓	✓	✓	✓	✓	✓	○	○
G 2-3/4	11	R GG 00234 011	✓	✓	✓	✓	✓	✓	○	○
G 3	11	R GG 00300 011	✓	✓	✓	✓	✓	✓	○	○
G 3-1/2	11	R GG 00312 011	○	○	○	○	○	○	○	○
G 4	11	R GG 00400 011	○	○	○	○	○	○	○	○
G 5	11	R GG 00500 011	○	○	○	○	○	○	○	○
G 6	11	R GG 00600 011	○	○	○	○	○	○	○	○



Specification: DIN 40430 / DIN 40431

**Application:** Checking threads of Conduit pipes used for electrical piping for wiring.

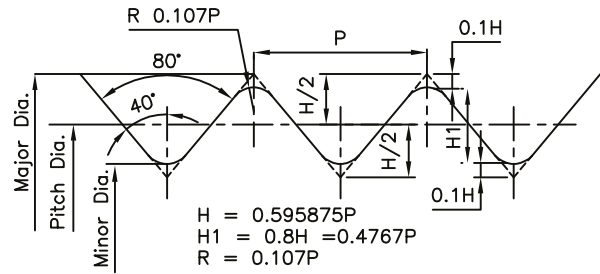

✓ Available in stock    ○ Manufactured against order

Size		Catalogue Code	Go & Nogo Plug RH	
	TPI		00 DR	
Pg 7	20	P PG 00007 020	✓	
Pg 9	18	P PG 00009 018	✓	
Pg 11	18	P PG 00011 018	✓	
Pg 13.5	18	P PG 00135 018	✓	
Pg 16	18	P PG 00016 018	✓	
Pg 21	16	P PG 00021 016	✓	
Pg 29	16	P PG 00029 016	✓	
Pg 36	16	P PG 00036 016	✓	
Pg 42	16	P PG 00042 016	✓	
Pg 48	16	P PG 00048 016	✓	

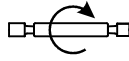

Nogo end is Plain without Threads.

✓ Available in stock    ○ Manufactured against order

Size		Catalogue Code	Go Ring RH		Nogo Ring Plain / Cylindrical	
Diameter	TPI		00 GR	00 NO		
Pg 7	20	R PG 00007 020	✓		✓	
Pg 9	18	R PG 00009 018	✓		✓	
Pg 11	18	R PG 00011 018	✓		✓	
Pg 13.5	18	R PG 00135 018	✓		✓	
Pg 16	18	R PG 00016 018	✓		✓	
Pg 21	16	R PG 00021 016	✓		✓	
Pg 29	16	R PG 00029 016	✓		✓	
Pg 36	16	R PG 00036 016	✓		✓	
Pg 42	16	R PG 00042 016	✓		✓	
Pg 48	16	R PG 00048 016	✓		✓	



Specification: **DIN 2999**

**Application :** Pipe threads, where pressure tight joints are required on threads.  
Taper 1 in 16 on diameter

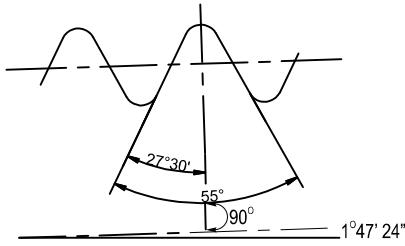

Taper 1 in 16 on diameter  
**Taper Thread Plug**

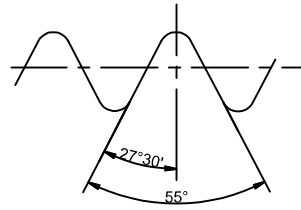

**Parallel Thread Ring**

## TAPER PLUG

✓ Available in stock   ○ Manufactured against order

Size		Catalogue Code		
	TPI		Taper Thread Plug	CP to check Ring
			00 TR	00 CR
R1/8	28	P RD 00108 028	✓	○
R1/4	19	P RD 00104 019	✓	○
R3/8	19	P RD 00308 019	✓	○
R1/2	14	P RD 00102 014	✓	○
R3/4	14	P RD 00304 014	✓	○
R1	11	P RD 00100 011	✓	○
R1-1/4	11	P RD 00114 011	✓	○
R 1-1/2	11	P RD 00112 011	✓	○
R 2	11	P RD 00200 011	✓	○
R 2-1/2	11	P RD 00212 011	✓	○
R 3	11	P RD 00300 011	✓	○
R 4	11	P RD 00400 011	✓	○



## PARALLEL RING

✓ Available in stock   ○ Manufactured against order

Size		Catalogue Code	
	TPI		Parallel Thread Ring
			00 PR
R1/8	28	R RD 00108 028	○
R1/4	19	R RD 00104 019	✓
R3/8	19	R RD 00308 019	✓
R1/2	14	R RD 00102 014	✓
R3/4	14	R RD 00304 014	✓
R1	11	R RD 00100 011	✓
R1-1/4	11	R RD 00114 011	✓
R 1-1/2	11	R RD 00112 011	✓
R 2	11	R RD 00200 011	✓
R 2-1/2	11	R RD 00212 011	✓
R 3	11	R RD 00300 011	✓
R 4	11	R RD 00400 011	○

Specification: **BS EN 10226 OR / ISO 7/2**

**Application** : Pipe threads, where pressure tight joints are required on threads.  
Taper 1 in 16 on diameter

### TAPER PLUG

To check Internal Parallel threads (Rp) & Taper threads (Rc).

✓ Available in stock   ○ Manufactured against order

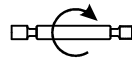
Size		Catalogue Code			
Diameter	TPI		Taper Full Form Thread Plug No.1	Taper Full Form Thread Plug with relief No. 2	Taper Modified Form Check Plug for Ring No. 5
R1/8	28	PRC 00108 028	✓	○	○
R1/4	19	PRC 00104 019	✓	○	○
R3/8	19	PRC 00308 019	✓	○	○
R1/2	14	PRC 00102 014	✓	○	○
R3/4	14	PRC 00304 014	✓	○	○
R1	11	PRC 00100 011	✓	○	○
R1-1/4	11	PRC 00114 011	✓	○	○
R 1-1/2	11	PRC 00112 011	✓	○	○
R 2	11	PRC 00200 011	✓	○	○
R 2-1/2	11	PRC 00212 011	✓	○	○
R 3	11	PRC 00300 011	✓	○	○
R 4	11	PRC 00400 011	✓	○	○

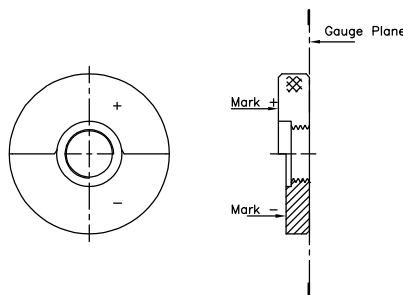

Parallel Full form Thread Ring Gauge. Gauge No.3

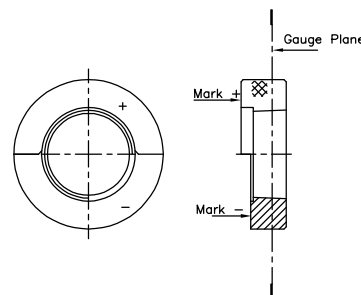

Taper Plain Ring Gauge (without threads) Gauge No.4



### RING

To check External Taper threads (R)

✓ Available in stock   ○ Manufactured against order

Size		Catalogue Code			
Diameter	TPI		Parallel Full Form Thread Ring No. 3	Taper Plain Ring No. 4	Parallel Modified Thread Form Ring No. 6
R1/8	28	R RC 00108 028	✓	○	○
R1/4	19	R RC 00104 019	✓	✓	○
R3/8	19	R RC 00308 019	✓	✓	○
R1/2	14	R RC 00102 014	✓	✓	○
R3/4	14	R RC 00304 014	✓	✓	○
R1	11	R RC 00100 011	✓	✓	○
R1-1/4	11	R RC 00114 011	✓	✓	○
R 1-1/2	11	R RC 00112 011	✓	✓	○
R 2	11	R RC 00200 011	✓	✓	○
R 2-1/2	11	R RC 00212 011	✓	○	○
R 3	11	R RC 00300 011	✓	○	○
R 4	11	R RC 00400 011	✓	○	○



Specification: **Basic ASME B 1.20.1**  
**Step Limit : American Handbook H-28**

**Application:** NPT threads are used in general purpose applications of pipe assembly, where a pressure tight joint of the pipes are made, by making the pipes wrench tight using a sealing compound.  
 Taper 1 in 16 on diameter

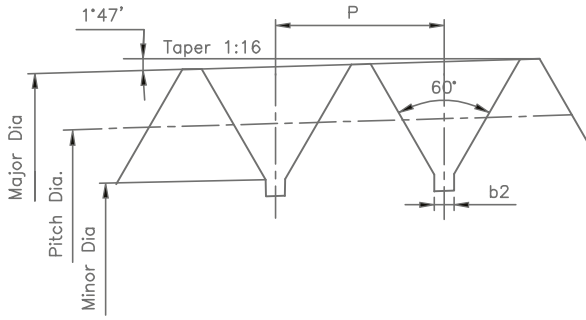

Our manufacturing program includes NPT L3 Plugs & NPT L2 Rings. **PRICES ON REQUEST**

✓ Available in stock    ○ Manufactured against order

Size			Thread Plug	
Diameter	TPI	Catalogue Code	L1 Basic	L1 Step Limit
			L1 BR	L1 SR
1/16	27	P NT 00116 027	✓	✓
1/8	27	P NT 00108 027	✓	✓
1/4	18	P NT 00104 018	✓	✓
3/8	18	P NT 00308 018	✓	✓
1/2	14	P NT 00102 014	✓	✓
3/4	14	P NT 00304 014	✓	✓
1	11.5	P NT 00100 115	✓	✓
1.1/4	11.5	P NT 00114 115	✓	✓
1.1/2	11.5	P NT 00112 115	✓	✓
2	11.5	P NT 00200 115	✓	✓
2.1/2	8	P NT 00212 008	✓	✓
3	8	P NT 00300 008	✓	✓
3.1/2	8	P NT 00312 008	○	○
4	8	P NT 00400 008	✓	✓
4.1/2	8	P NT 00412 008	○	○
5	8	P NT 00500 008	○	○
6	8	P NT 00600 008	○	○
8	8	P NT 00800 008	○	○
10	8	P NT 01000 008	○	○
12	8	P NT 01200 008	○	○

Size			Thread Ring	
Diameter	TPI	Catalogue Code	L1 Basic	L1 Step Limit
			L1 BR	L1 SR
1/16	27	R NT 00116 027	✓	✓
1/8	27	R NT 00108 027	✓	✓
1/4	18	R NT 00104 018	✓	✓
3/8	18	R NT 00308 018	✓	✓
1/2	14	R NT 00102 014	✓	✓
3/4	14	R NT 00304 014	✓	✓
1	11.5	R NT 00100 115	✓	✓
1.1/4	11.5	R NT 00114 115	✓	✓
1.1/2	11.5	R NT 00112 115	✓	✓
2	11.5	R NT 00200 115	✓	✓
2.1/2	8	R NT 00212 008	✓	✓
3	8	R NT 00300 008	✓	✓
3.1/2	8	R NT 00312 008	○	○
4	8	R NT 00400 008	✓	✓
4.1/2	8	R NT 00412 008	○	○
5	8	R NT 00500 008	○	○
6	8	R NT 00600 008	○	○
8	8	R NT 00800 008	○	○
10	8	R NT 01000 008	○	○

• ANPT Gauges are in our manufacturing program. **PRICES ON REQUEST**

Specification: **ASME B 1.20.6**  
**ASME B 1.20.5**

**Application:** NPTF threads can provide pressure tight seal on threads without the use of a sealing compound (dry seal type) PTF are short gauges (less thickness) which are used for application similar to NPTF Taper 1 in 16 on diameter



Our manufacturing program includes PTF- SAE SHORT, NPSF & NPSI gauges **PRICES ON REQUEST**

**TAPER PLUGS**

Available in stock  Manufactured against order

Size		Catalogue Code	Thread Plug	Thread Plug	Thread Plug	Thread Plug	6 Step Crest Truncation Plug
Diameter	TPI		L1 Basic	L1 Step Limit	L3 Basic	L3 Step Limit	
			L1 BR	L1 SR	L3 BR	L3 SR	CT 06
1/16	27	P TF 00116 027	✓	✓	○	○	○
1/8	27	P TF 00108 027	✓	✓	○	○	○
1/4	18	P TF 00104 018	✓	✓	○	○	○
3/8	18	P TF 00308 018	✓	✓	○	○	○
1/2	14	P TF 00102 014	✓	✓	○	○	○
3/4	14	P TF 00304 014	✓	✓	○	○	○
1	11.5	P TF 00100 115	✓	✓	○	○	○
1.1/4	11.5	P TF 00114 115	✓	✓	○	○	○
1.1/2	11.5	P TF 00112 115	✓	✓	○	○	○
2	11.5	P TF 00200 115	✓	✓	○	○	○
2.1/2	8	P TF 00212 008	✓	✓	○	○	○
3	8	P TF 00300 008	✓	✓	○	○	○

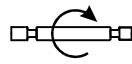

**TAPER RINGS**

Available in stock  Manufactured against order

Size		Catalogue Code	Thread Ring	Thread Ring	Thread Ring	Thread Ring	6 Step Crest Truncation Ring
Diameter	TPI		L1 Basic	L1 Step Limit	L2 Basic	L2 Step Limit	
			L1 BR	L1 SR	L2 BR	L2 SR	CT 06
1/16	27	R TF 00116 027	✓	✓	○	○	○
1/8	27	R TF 00108 027	✓	✓	○	○	○
1/4	18	R TF 00104 018	✓	✓	○	○	○
3/8	18	R TF 00308 018	✓	✓	○	○	○
1/2	14	R TF 00102 014	✓	✓	○	○	○
3/4	14	R TF 00304 014	✓	✓	○	○	○
1	11.5	R TF 00100 115	✓	✓	○	○	○
1.1/4	11.5	R TF 00114 115	✓	✓	○	○	○
1.1/2	11.5	R TF 00112 115	✓	✓	○	○	○
2	11.5	R TF 00200 115	✓	✓	○	○	○
2.1/2	8	R TF 00212 008	✓	✓	○	○	○
3	8	R TF 00300 008	✓	✓	○	○	○

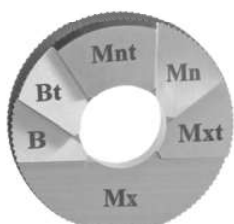

Crest Truncation 6 steps



Specification: **CGA V -1 / American Handbook H-28**
**Application:** Used for checking Gas cylinder valve stems and cylinder neck threads.  
Taper 1 in 16 on diameter

**TAPER PLUGS**

✓ Available in stock    ○ Manufactured against order

Size		Catalogue Code					
Diameter	TPI		Taper Thread Plug L1	Taper Thread Plug L9	CP to check L1 & L8 Rings	Taper Plain Plug C1	Taper Plain Plug C2
			L1 0R	L9 0R	CP 0R	C1 00	C2 00
1/8	27	P NG 00108 027	○	○	○	○	○
1/4	18	P NG 00104 018	○	○	○	○	○
3/8	18	P NG 00308 018	○	○	○	○	○
1/2	14	P NG 00102 014	○	○	○	○	○
3/4	14	P NG 00304 014	✓	✓	✓	✓	✓
1	11.5	P NG 00100 115	○	○	○	○	○
1-1/2	11.5	P NG 00112 115	○	○	○	○	○

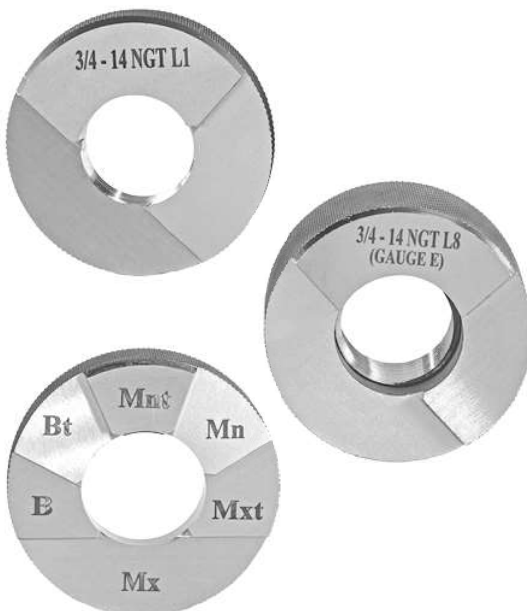

3/4-14 NGT Crest Truncation Ring

**TAPER RINGS**

✓ Available in stock    ○ Manufactured against order

Size		Catalogue Code			
Diameter	TPI		Taper Thread Ring L1	Taper Thread Ring L8	Crest Truncation Ring (6 Steps) CR 06
			L1 0R	L8 0R	CR 06
1/8	27	R NG 00108 027	○	○	○
1/4	18	R NG 00104 018	○	○	○
3/8	18	R NG 00308 018	○	○	○
1/2	14	R NG 00102 014	○	○	○
3/4	14	R NG 00304 014	✓	✓	✓
1	11.5	R NG 00100 115	○	○	○
1-1/2	11.5	R NG 00112 115	○	○	○

 Gauges for Chlorine gas cylinder & oversize valves (CL-2, CL-3, CL-4, CL-5) are in our manufacturing program. **PRICES ON REQUEST**

- other than LPG (TAPER 3 IN 25)

Specification: **BS EN ISO 11363**

**Application:** Valves of containers used for the conveyance of permanent, Liquefiable and Dissolved Gases up to working pressure 400 Bar. Valves of Breathing Apparatus, Fire Extinguishers.



Our manufacturing program includes gauges as per BS 341-1963, BS 341-1991, & DIN 477. PRICES ON REQUEST

✓ Available in stock   ○ Manufactured against order

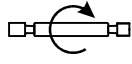
Size		Catalogue Code						
	TPI		Single Part Thread Plug Gauge I-2	2 Part Thread Plug to check Pitch Dia. at small end Gauge I-4	2 Part Thread Plug to check Pitch Dia. at large end Gauge I-6	Single Part Plain Plug Gauge I-1	2 Part Plain Plug to check Pitch Dia. at small end Gauge I-3	2 Part Plain Plug to check Pitch Dia. at large end Gauge I-5
17E	14	P GS 00017 014	✓	✓	✓	✓	✓	✓
25E	14	P GS 00025 014	✓	✓	✓	✓	✓	✓

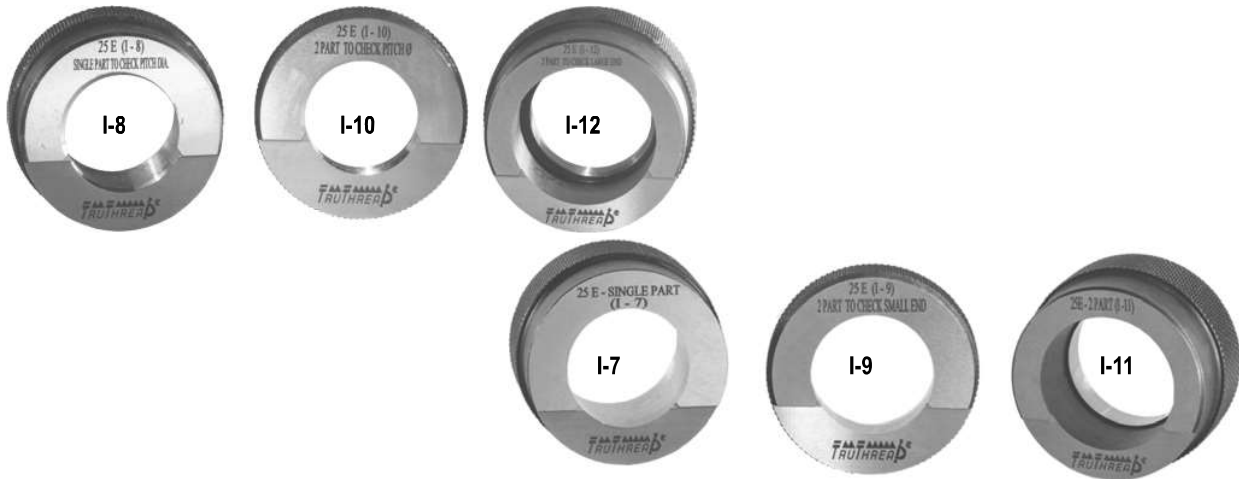

✓ Available in stock   ○ Manufactured against order

Size		Catalogue Code						
	TPI		Single Part Thread Ring Gauge I-8	2 Part Thread Ring to check Pitch Dia. at small end Gauge I-10	2 Part Thread Ring to check Pitch Dia. at large end Gauge I-12	Single Part Plain Ring Gauge I-7	2 Part Plain Ring to check Pitch Dia. at small end Gauge I-9	2 Part Plain Ring to check Pitch Dia. at large end Gauge I-11
17E	14	R GS 00017 014	✓	✓	✓	✓	✓	✓
25E	14	R GS 00025 014	✓	✓	✓	✓	✓	✓

## Calibration Certificates

www.truthread.com				
<b>Truthread Gauges &amp; Tools Pvt. Ltd.</b> H-9/2, CH. T-83, A-1, D.C. BHOSARI, PUNE - 411 004, INDIA. Tel. : 91-20-4076 9500, 4076 9505. 4078 1234. CIN : U17231PN1982PTCO23669				
CALIBRATION CERTIFICATE				
Receipt Date 27/07/2021	Calibration Date 28/07/2021	Issue Date 28/07/2021	Next due Date (by customer)	Certificate No. <b>N2021/01034</b>
Customer Name & Address. M/s. Industrial Enterprises, Pvt. Ltd. Plot No. 10, Phase 1, Ch. T-83, A-1, D.C. Bhosari, Pune - 411 004, India.				
Description / Size: <b>2-12 UN 2B Go &amp; Nogo Plug</b> Specification: ASME B 1.2-1983 Calibration Procedure: As per Calibration Procedure No. TTG/CL/CI.05 <b>1. Mechanical Calibration 1. Dimension [Basic Measuring Instruments, Gauge etc.]</b>				
Equipment & Masters used for Calibration		Traceability		
Floating Carriage Micrometer		Calibrated by NABL accredited Lab No. CC2656, Certificate No. CGIL/2021/0426/E-002 Dated 26/04/2021 valid up to 25/04/2023		
Cylindrical Setting Master		Calibrated by NABL accredited Lab No. CC2656, Certificate No. CGIL/2021/0603/C-002 dated 04/06/2021 valid up to 03/06/2023		
Thread Measuring Wires (2 Wire unit)		Calibrated by NABL accredited Lab No. CC2656, Certificate No. CGIL/2021/0603/C-001 dated 04/06/2021 valid up to 03/06/2023		
Measurements are traceable to SI units through unbroken chain of calibration by NMI /ISO 17025 accredited laboratories. * Measurement uncertainty is at coverage factor k =2, coverage probability of 95-45% for normal distribution.				
CALIBRATION RESULTS (Unit of Measurement -mm)				
Parameter / size	Specified	Actual Reading	* Measurement Uncertainty	Remarks
<b>GO Make - Truthread ID.No. AB43688 / DB92361</b>				
Major Diameter	50.8000±0.0152	50.8132 / 50.8140	± 0.0018	
Pitch Diameter	49.4258±0.0102	49.4326 / 49.4329	± 0.0018	
<b>NOGO Make - Truthread ID.No. AB43688 / DC29724</b>				
Major Diameter	50.5434±0.0152	50.5320 / 50.5324	± 0.0018	
Pitch Diameter	49.6265±0.0102	49.6208 / 49.6213	± 0.0018	
Environmental Conditions Temp. 20.4°C Humidity 52.1 % RH		Calibrated By: Ritu Gupta Calibration Engineer		Authorized By: Kirti Kulkarni Cal. Lab Manager
§ This certificate is digitally approved & does not require Signature. 1) This certificate shall not be reproduced, except in full, unless written permission for abridged is obtained from Truthread Gauges & Tools Pvt. Ltd. 2) Calibration results reported in this certificate are valid at the time of and under the stated conditions of measurement. 3) This certificate refers only to the particular item(s) submitted for calibration.				
----- END OF CERTIFICATE -----				
POA/2021-22/0888	Did. 27/07/2021	OUT/14465	TTG/CL/FR.28 [Issue/ date: 01/15 Feb 20/Rev/ date: 01/28 Oct 20]	Page 1 of 1

Calibration certificate issued by our Lab accredited for ISO 17025 standard with ILAC-MRA logo. As per MRA (Mutual recognition agreement), this certificate is accepted across the world. (A4 Size)

www.truthread.com				
<b>Truthread Gauges &amp; Tools Pvt. Ltd.</b> Calibration Certificate				
Customer	M/s. Industrial Enterprises, Pvt. Ltd.			Certificate No. S21/014888
Size	M18-8g Go Ring			Issue Date: 06/08/2021
Specification	ISO 965-2013 & Gauging Practice ISO 1502-1996			Dimensions in mm
Calibrated Parameters	GO ID No. EA69508		NOGO ID No.	
	Specified	Observed	Specified	Observed
Major Diameter	Min. 18.1495	Clearing OK		
Pitch Diameter	16.3260 ± 0.0090	16.326		
Minor Diameter	15.2520 ± 0.0090	15.248		
Pitch Error	2.5000 ± 0.0050	0.002		
Flank Angle	30° ± 10'	30° 3' 29" 56"		
Measurements Carried out at 20 ± 1 °C & RH 50 ± 10. Measurements are traceable to SI units through unbroken chain of Calibration by NMI/ISO 17025 accredited Laboratories. OUT/41099/ EA69508 ) Calibrated By- Rajesh Gawari				
TTG/QR/13 [Issue/ date: 00/15 Feb 20/Rev/ date: 00/15 Feb 20] § This certificate is digitally approved & does not require Signature.				

Calibration certificate issued with each gauge free of cost. Though small in size it covers all important parameters of Threads. (Size : 21x10cms.)

Our esteemed customers are spread in all types of Engineering industries



- ┆ Automobiles & components.
- ┆ Aerospace.
- ┆ Agro equipment.

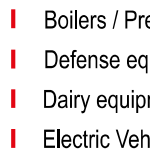

- ┆ Boilers / Pressure vessels.
- ┆ Defense equipment.
- ┆ Dairy equipment.
- ┆ Electric Vehicles



- ┆ Fasteners.
- ┆ Hydraulics.
- ┆ Machine tools.
- ┆ Oli & Gas



- ┆ Medical Equipment
- ┆ Pneumatics.
- ┆ Scuba diving equipment



Disclaimer: The world map is a graphic representation. We have made efforts for its accuracy, but still, some inaccuracies may be present due to the limitations of the size of the map. These errors are unintentional.

*Our satisfied Customers are spread all over the world.*



*We have established a marketing office and warehouse in Central Europe, in the city of Wrocław, Poland. This is to facilitate easy access to our European customers.*

*We have chosen this location due to the rapidly developing market in Central and Eastern Europe. This region is well connected to all the major cities in Europe.*

*This is our first establishment in Europe. Our warehouse stocks a wide range of standard gauges. This catalogue shows the gauges normally available in our warehouse.*

*Our professionally trained team is happy to serve our customers with quality products, quick & efficient service, and a short delivery time.*

***Team Tru-Thread Europe***

*Distributed by*



**Tru-Thread Europe Sp. z o.o.**

ul. Wrocławska 13, 55-100 Trzebnica POLAND

Phone No. + 48 609 002 085

Email: [contact@truthread.eu](mailto:contact@truthread.eu) [www.truthread.eu](http://www.truthread.eu)

**Tru-Thread Gauges & Tools Pvt. Ltd.**

H.O. T-83, M.I.D.C. Bhosari, Pune-411 026. INDIA

Phone No. +91-20-4676 9500 / 4676 9505 / 4678 1234

Email: [export@truthread.com](mailto:export@truthread.com) [www.truthread.com](http://www.truthread.com)

*Photographs, images & text used in this catalogue is the intellectual property of Truthread Gauges & Tools Pvt. Ltd. India and is protected by copy right. Any unauthorized use of these is prohibited & will attract legal action.*